

0.4 MILES TO CROTON POINT PARK

0.2 MILES TO CROTON-HARMON TRAIN STATION

N/F Metro-North Commuter Railroad Company

N/F Metro-North Commuter Railroad Company

N/F N.Y.S. Department of Public Works

EXISTING METRO NORTH INGRESS/EGRESS EASEMENT

Croton Point Avenue

N.Y.S. Route 9 (Exit Ramp)

N.Y.S. Route 9 (SH 657)

N.Y.S. Route 9 (On Ramp)

ROOFTOP TERRACE WITH PLANTINGS

PROPOSED 5 STORY BUILDING

PROPOSED ASPHALT PAVEMENT

APPROXIMATE LOCATION OF POTENTIAL WATER MAIN EXTENSION FROM WAYNE STREET TO CROTON POINT AVENUE

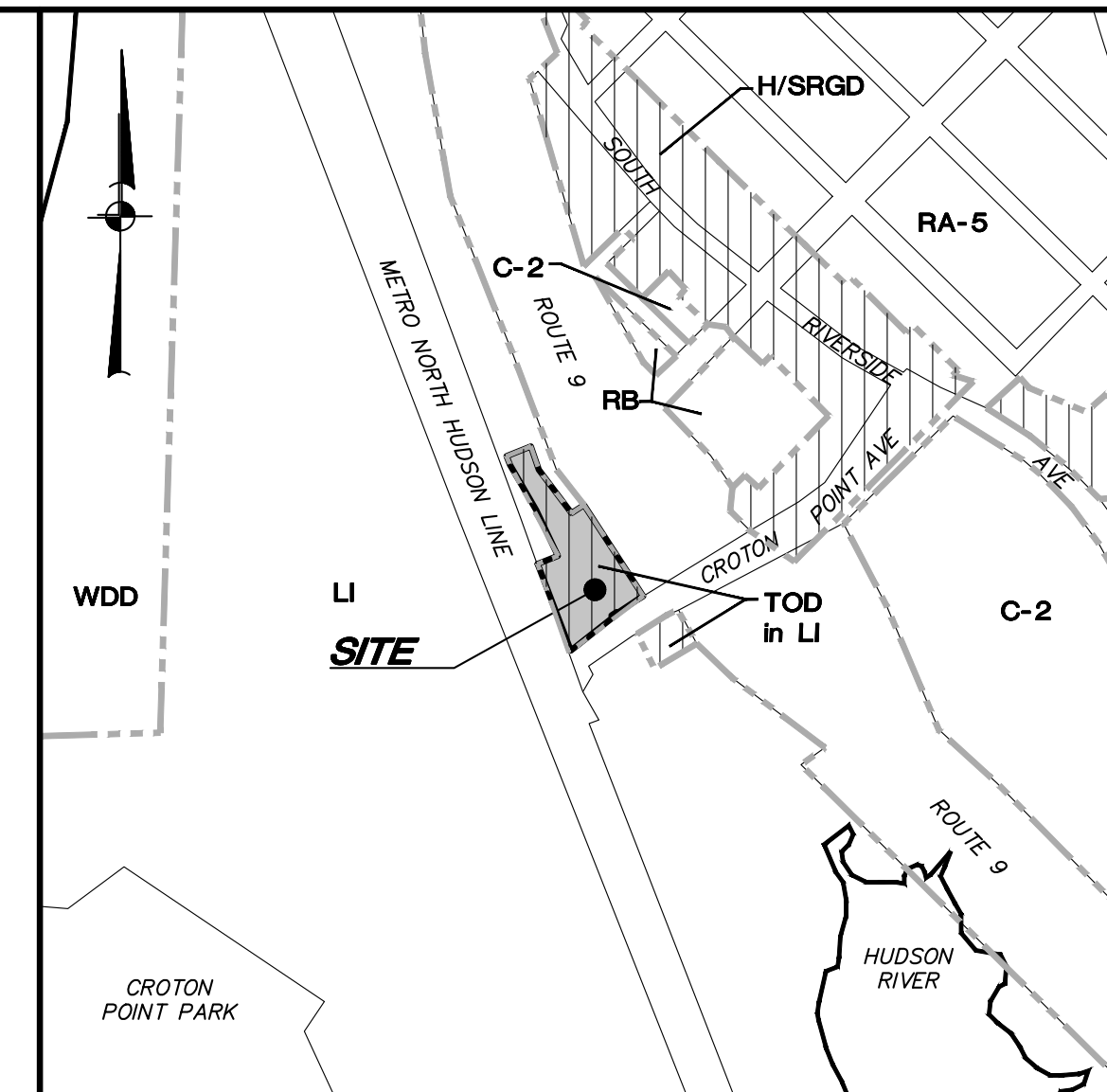

LOCATION MAP SCALE: 1" = 500'±

**OWNER (LOTS 3&5):**

VILLAGE OF CROTON-ON-HUDSON  
1 VAN WYCK STREET  
CROTON-ON-HUDSON, NY 10520

**OWNER (LOT 4):**

CROTON POINT REALTY, INC  
1 CROTON POINT AVE  
CROTON-ON-HUDSON, NY 10520

**SPONSOR / DEVELOPER:**

WBP DEVELOPMENT, LLC  
480 BEDFORD ROAD  
CHAPQUAN, NY 10514-1715

**SITE DATA:**

Zone: LI-Light Industrial with a  
TOD-Transitoriented Development Overlay  
Total Acreage: 1.7578 AC.±  
Tax Map Nos.:  
1. 79.17-1-3 0.2205 AC.±  
2. 79.17-1-4 0.2884 AC.±  
3. 79.17-1-5 1.2489 AC.±

**GENERAL NOTES:**

- Property lines, existing conditions and topography shown hereon field located by Insite Engineering, Surveying & Landscape Architecture, P.C. Topographic datum is NAVD 1988.
- Aerial orthomography shown hereon is taken from Google Earth Pro, dated May 10, 2023.

**LEGEND**

	EXISTING PROPERTY LINE
	EXISTING GUIDE RAIL
	EXISTING CHAIN LINK FENCE
	EXISTING POST & RAIL FENCE
	EXISTING CURB
	EXISTING SIGN
	PROPOSED CONCRETE CURB

**GRAPHIC SCALE**

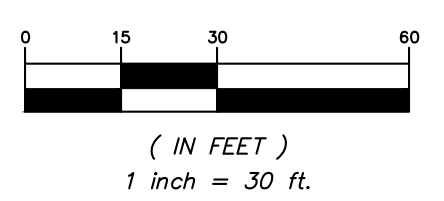

NO.	DATE	REVISION	BY

**INSITE**  
ENGINEERING, SURVEYING & LANDSCAPE ARCHITECTURE, P.C.  
3 Garrett Place  
Croton, NY 10512  
(845) 225-9690  
(845) 225-9717 fax  
www.insite-eng.com

PROJECT: **1 CROTON POINT**  
CROTON POINT AVE & VETERANS PLAZA, VILLAGE OF CROTON-ON-HUDSON, WESTONESTER CO., NY

DRAWING: **OVERALL PLAN**

PROJECT NUMBER	24154.100	PROJECT MANAGER	R.D.W.	DRAWING NO.	SHEET
DATE	7-11-24	DRAWN BY	M.E.U.	OP-1	1
SCALE	1" = 30'	CHECKED BY	D.L.M.		7

ALTERATION OF THIS DOCUMENT, UNLESS UNDER THE DIRECTION OF A LICENSED PROFESSIONAL ENGINEER, IS A VIOLATION OF SECTION 2209 OF ARTICLE 145 OF THE EDUCATION LAW.

2:10/24/2024 9:59 AM C:\Users\Public\OneDrive\Documents\24154.100\24154.100\_01.dwg 3/1/2024 12:52:28 PM, Title: 1

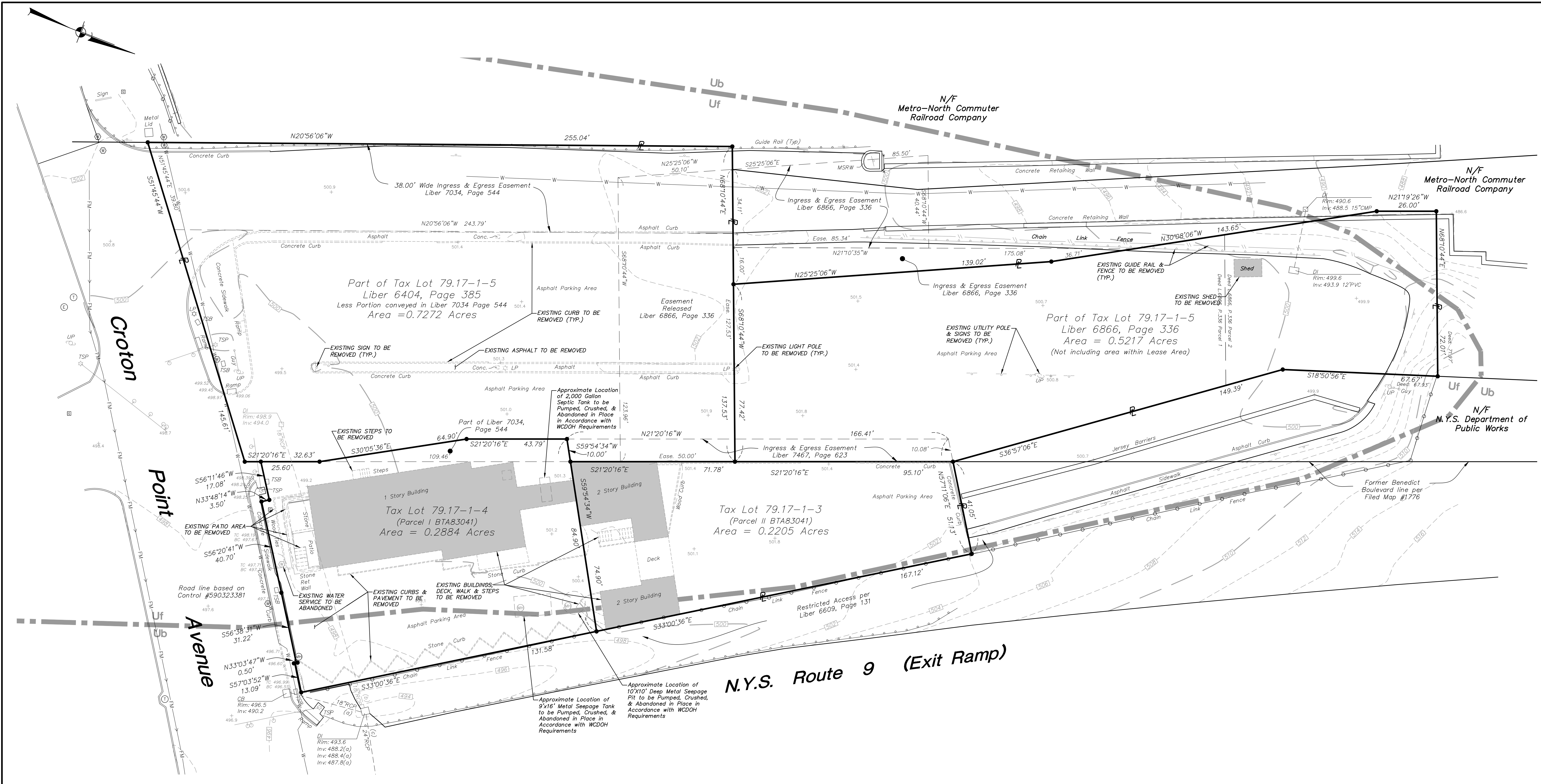

**LEGEND**

	EXISTING PROPERTY LINE
	EXISTING EASEMENT
	EXISTING GUIDE RAIL
	EXISTING CHAIN LINK FENCE
	EXISTING POST & RAIL FENCE
	EXISTING CURB
	EXISTING SIGN
	EXISTING UTILITY POLE WITH GUY WIRE
	EXISTING TRAFFIC SIGNAL POLE WITH ARM
	EXISTING LIGHT POLE
	EXISTING TRAFFIC SIGNAL BOX
	EXISTING UNDERGROUND DRAINAGE PIPE
	EXISTING CATCH BASIN
	EXISTING WATER VALVE
	EXISTING GAS VALVE
	EXISTING BUILDING TO BE REMOVED

**SOILS LEGEND**

SOILS	DESCRIPTION	HYDROLOGICAL GROUP
Ub	Udorthents, smoothed	B
Uf	Urban Land	
NRCS Soil Boundary Line		

**GENERAL NOTES:**

- Location of existing sewer force main shown hereon along Croton Point Avenue is approximate and obtained from a drawing titled "Croton Point Landfill Leachate Collection System" prepared by Goss & Hill Inc., dated May 10th, 1991, and is shown in design location.
- Location of existing water service shown hereon in Metro North Rail-Road Easement is approximate and obtained from a survey titled "Boundary Survey North of Croton Station" prepared by Walsh Engineering & Land Surveying, P.C., dated August 9, 2017.

ALTERATION OF THIS DOCUMENT, UNLESS UNDER THE DIRECTION OF A LICENSED PROFESSIONAL ENGINEER, IS A VIOLATION OF SECTION 2209 OF ARTICLE 145 OF THE EDUCATION LAW.

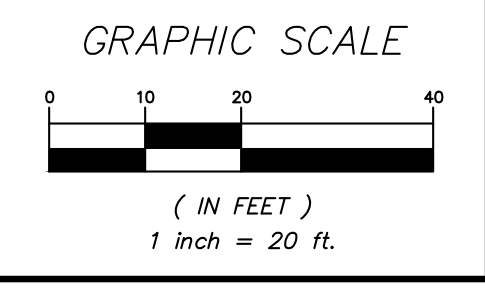

NO.	DATE	REVISION	BY
<b>PROJECT:</b> 1 CROTON POINT CROTON POINT AVE. & VETERANS PLAZA, VILLAGE OF CROTON-ON-HUDSON, WESTCHESTER CO., NY			
<b>DRAWING:</b> EXISTING CONDITIONS & REMOVALS PLAN			
PROJECT NUMBER	24154.100	PROJECT MANAGER	R.D.W.
DATE	7-11-24	DRAWN BY	M.E.U.
SCALE	1" = 20'	CHECKED BY	D.L.M.
DRAWING NO.	EX-1	SHEET	2 / 7





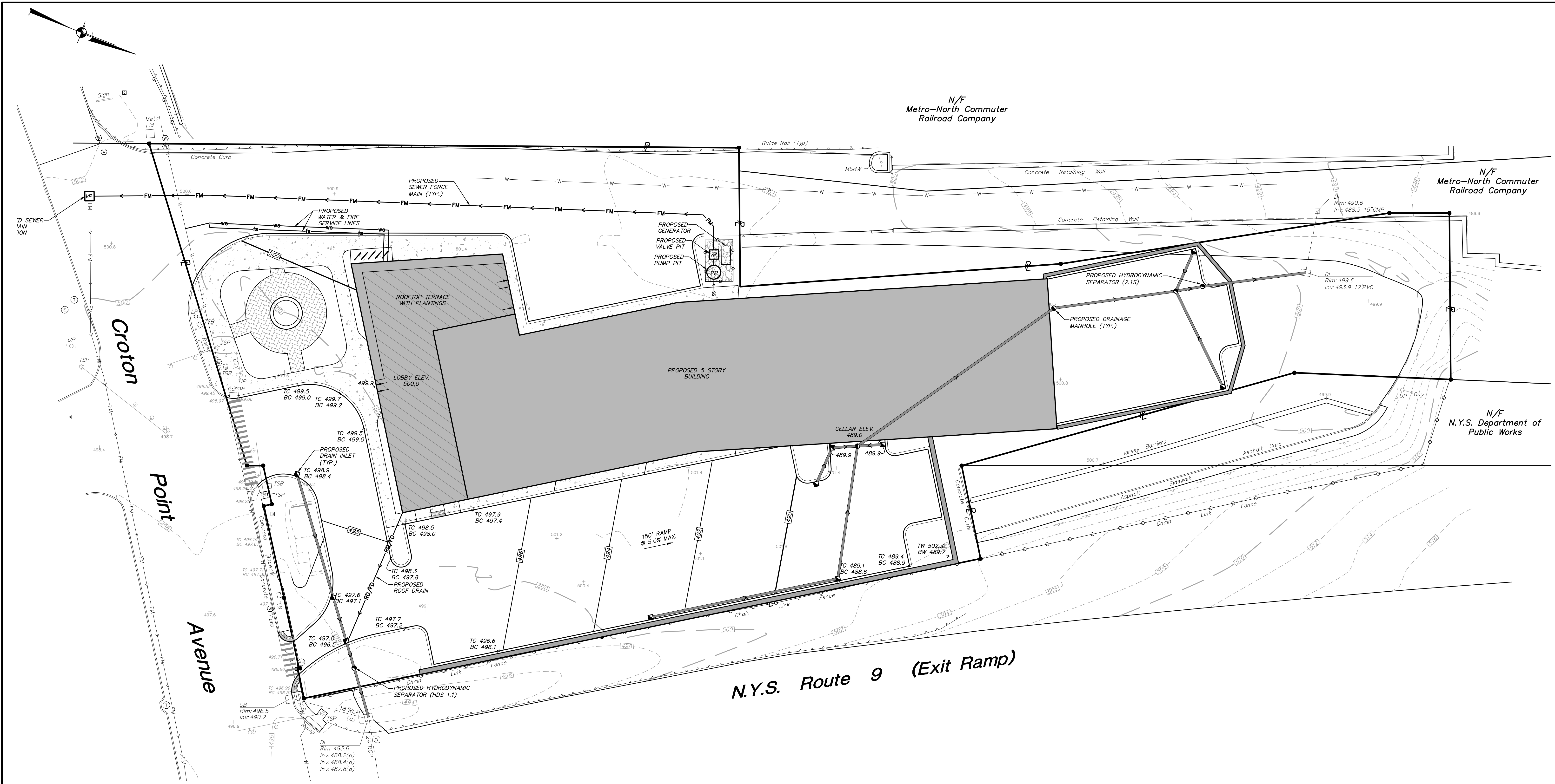

**LEGEND**

	EXISTING PROPERTY LINE
	EXISTING GUIDE RAIL
	EXISTING CHAIN LINK FENCE
	EXISTING POST & RAIL FENCE
	EXISTING CURB
	EXISTING SIGN
	EXISTING UTILITY POLE WITH GUY WIRE
	EXISTING TRAFFIC SIGNAL POLE WITH ARM
	EXISTING LIGHT POLE
	EXISTING TRAFFIC SIGNAL BOX
	EXISTING UNDERGROUND DRAINAGE PIPE
	EXISTING CATCH BASIN
	EXISTING WATER VALVE
	EXISTING GAS VALVE
	PROPOSED 10' CONTOUR
	PROPOSED 2' CONTOUR
	PROPOSED SPOT ELEVATION
	PROPOSED TOP OF CURB & BOTTOM OF CURB ELEVATIONS
	PROPOSED SEWER MANHOLE
	PROPOSED DRAINAGE MANHOLE
	PROPOSED CATCH BASIN
	PROPOSED OUTLET STRUCTURE
	PROPOSED END SECTION
	PROPOSED WATER GATE VALVE
	PROPOSED FIRE HYDRANT
	PROPOSED WELL
	PROPOSED WATER SHUT OFF VALVE
	PROPOSED WATER VALVE
	PROPOSED DRAINAGE PIPE
	PROPOSED SEWER MAIN
	PROPOSED SEWER FORCE MAIN
	PROPOSED SEWER SERVICE LINE
	PROPOSED GREY WATER MAIN
	PROPOSED FIRE WATER SERVICE LINE
	PROPOSED FIRE SERVICE LINE
	PROPOSED DOMESTIC WATER SERVICE LINE
	PROPOSED WATER MAIN
	PROPOSED GRASS SWALE
	PITCH TO DRAIN
	PROPOSED CLEAN OUT

N.Y.S. Route 9 (Exit Ramp)

Croton Point Avenue

N/F Metro-North Commuter Railroad Company

N/F Metro-North Commuter Railroad Company

N/F N.Y.S. Department of Public Works

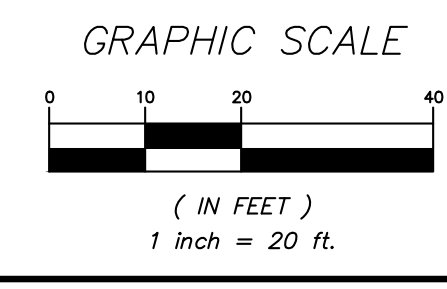

ALTERATION OF THIS DOCUMENT, UNLESS UNDER THE DIRECTION OF A LICENSED PROFESSIONAL ENGINEER, IS A VIOLATION OF SECTION 2209 OF ARTICLE 145 OF THE EDUCATION LAW.

NO.	DATE	REVISION	BY
 <b>INSITE</b> ENGINEERING, SURVEYING & LANDSCAPE ARCHITECTURE, P.C.			
PROJECT: <b>1 CROTON POINT</b> CROTON POINT AVE. & VETERANS PLAZA, VILLAGE OF CROTON-ON-HUDSON, WESTCHESTER CO., NY.			
DRAWING: <b>GRADING &amp; UTILITIES PLAN</b>			
PROJECT NUMBER	24154.100	PROJECT MANAGER	R.D.W.
DATE	7-11-24	DRAWN BY	M.E.U.
SCALE	1" = 20'	CHECKED BY	D.L.M.
DRAWING NO.			SHEET
SP-2			4 / 7



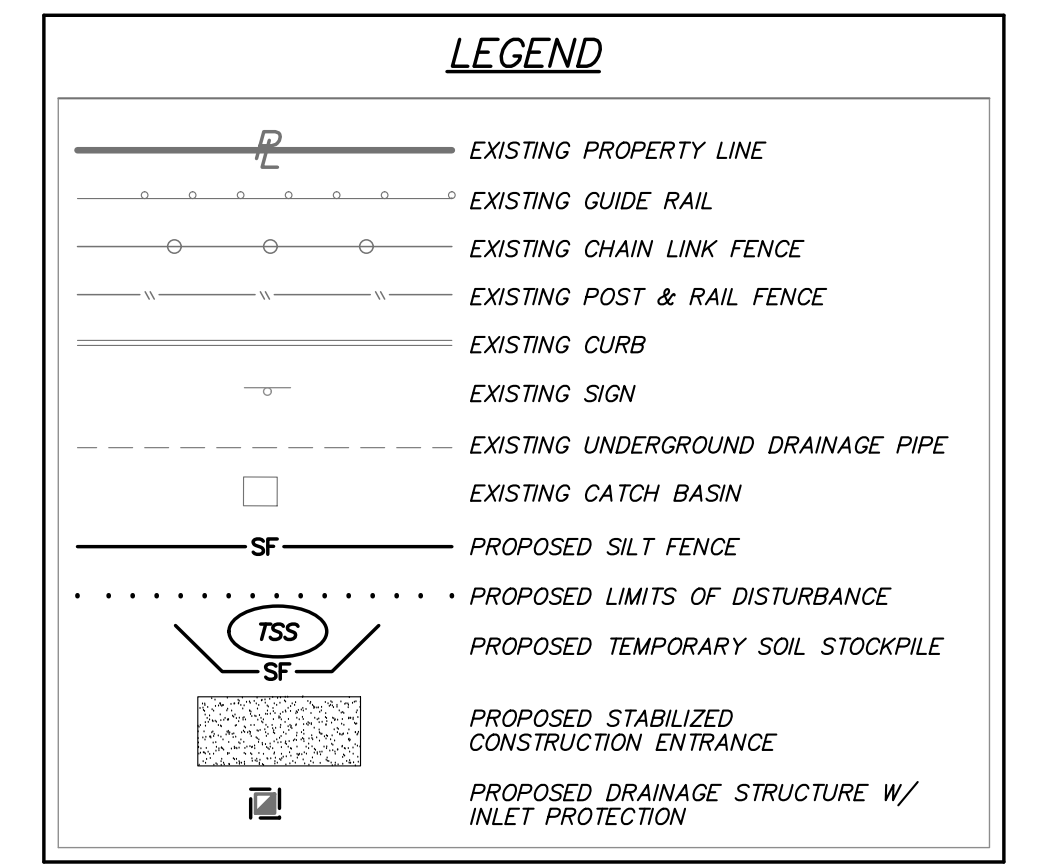
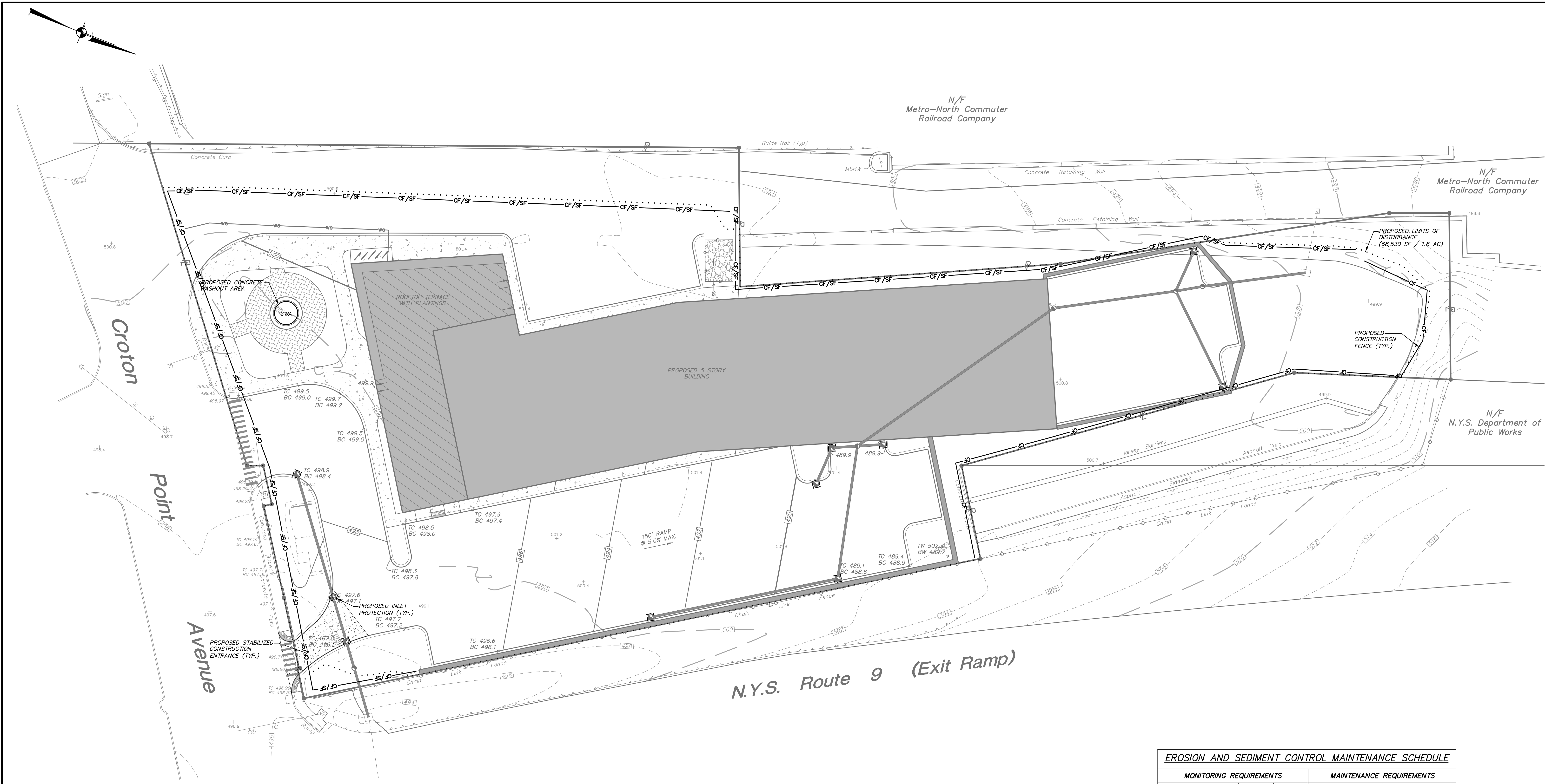

- EROSION & SEDIMENT CONTROL NOTES:**
- The owner's field representative (O.F.R.) will be responsible for the implementation and maintenance of erosion and sediment control measures on this site prior to and during construction.
  - All construction activities involving the removal or disposal of soil are to be provided with appropriate protective measures to minimize erosion and contain sediment disposition within. Minimum soil erosion and sediment control measures shall be implemented as shown on the plans and shall be installed in accordance with "New York Standards and Specifications For Erosion and Sediment Control," latest edition.
  - Wherever feasible, natural vegetation should be retained and protected. Disturbance shall be minimized in the areas required to perform construction. No more than 5 acres of unprotected soil shall be exposed at any one time.
  - When land is exposed during development, the exposure shall be kept to the shortest practical period of time. In the areas where soil disturbance activity has temporarily or permanently ceased, the application of soil stabilization measures must be initiated by the end of the next business day and completed within fourteen (14) days from the date the current soil disturbance activity ceased. Disturbance shall be minimized to the areas required to perform construction.
  - Silt fence shall be installed as shown on the plans prior to beginning any clearing, grubbing or earthwork.
  - All topsoil to be stripped from the area being developed shall be stockpiled and immediately used for temporary stabilization. Ryegrass (annual or perennial) at a rate of 30 lbs. per acre shall be used for temporary seeding in spring, summer or early fall. "Aristocrat" Winter Rye (cereal rye) shall be used for temporary seeding in late fall and winter.
  - Any disturbed areas not subject to further disturbance or construction traffic, permanent or temporary, shall have soil stabilization measures initiated for permanent vegetation cover in combination with a suitable mulch within 1 business day of final grading. All seeded areas to receive a minimum 4" topsoil (from stockpile area) and be seeded and mulched as follows:  
Seed mixture to be planted between March 21 and May 20, or between August 15 and October 15 or as directed by project representative at a rate of 100 pounds per acre in the following proportions:  
Kentucky Bluegrass 20%  
Creeping Red Fescue 40%  
Perennial Ryegrass 20%  
Annual Ryegrass 20%  
Mulch: Salt hay or small grain straw applied at a rate of 90 lbs./1000 S.F. or 2 tons/acre, to be applied and anchored according to "New York Standards and Specifications For Erosion and Sediment Control," latest edition.
  - Grass seed mix may be applied by either mechanical or hydrosowing methods. Seeding shall be performed in accordance with the current edition of the NYSDOT Standard Specification, Construction and Materials, Section 610-3.02, Method No. 1". Hydrosowing shall be performed using materials and methods as approved by the site engineer.
  - Cut or fill slopes steeper than 2:1 shall be stabilized immediately after grading with Curlex I Single Net Erosion Control Blanket, or approved equal.
  - Paved roadways shall be kept clean at all times.
  - The site shall at all times be graded and maintained such that all stormwater runoff is diverted to soil erosion and sediment control facilities.
  - All storm drainage outlets shall be stabilized, as required, before the discharge points become operational.
  - Stormwater from disturbed areas must be passed through erosion control barriers before discharge beyond disturbed areas or discharged into other drainage systems.
  - Erosion and sediment control measures shall be inspected and maintained on a daily basis by the O.F.R. to insure that channels, temporary and permanent catches and pipes are clear of debris, that embankments and berms have not been breached and that all silt fences and silt fences are intact. Any failure of erosion and sediment control measures shall be immediately repaired by the contractor and inspected for approval by the O.F.R. and/or site engineer.
  - Dust shall be controlled by sprinkling or other approved methods as necessary, or as directed by the O.F.R.
  - Cut and fills shall not endanger adjoining property, nor divert water onto the property of others.
  - All fills shall be placed and compacted in 6" lifts to provide stability of material and to prevent settlement.
  - The O.F.R. shall inspect downstream conditions for evidence of sedimentation on a weekly basis and after rainstorms.
  - As warranted by field conditions, special additional erosion and sediment control measures, as specified by the site engineer and/or the Town Engineer shall be installed by the contractor.
  - Erosion and sediment control measures shall remain in place until all disturbed areas are suitably stabilized.

**REQUIRED EROSION CONTROL SWPPP CONTENTS:**

- Pursuant to the NYSDEC "SPDES General Permit for Stormwater Discharges from Construction Activity" (GP-0-20-001), all Stormwater Pollution Prevention Plans (SWPPP) shall include erosion and sediment control practices designed in conformance with the most current version of the technical standard, "New York Standards and Specifications for Erosion and Sediment Control." Where erosion and sediment control practices are not designed in conformance with this technical standard, the owner or operator must demonstrate equivalence to the technical standard. The following list of required SWPPP components is provided in accordance with Part III.B.1.a-i of General Permit (GP-0-20-001):
- Background information: The subject project consists of the construction of a 100 Unit affordable condominium building.
  - Site map / construction drawing: These plans serve to satisfy this SWPPP requirement.
  - Description of the soils present at the site: Onsite soils located within the proposed limits of disturbance consist of Urban land (U1), Urban land-Riverhead complex (U4C), and U4rthens, smoothed (U4s), as identified on the Soil Conservation Service Web Soil Survey. These soil types belong to the Hydrologic Soil Group "B" and "D."
  - Construction phasing plan / sequence of operations: The Construction Sequence and phasing found on these plans provide the required phasing. A Construction Sequence and Erosion and Sediment Control Maintenance Schedule has been provided. The Erosion and Sediment Control Notes contained herein outline a general sequence of operations for the proposed project. In general all erosion and sediment control facilities shall be installed prior to commencement with land disturbing activities, and areas of disturbance shall be limited to the shortest period of time as practicable.
  - Description of erosion and sediment control practices: This plan, and details / notes shown hereon serve to satisfy this SWPPP requirement.
  - Temporary and permanent soil stabilization plan: The Sedimentation and Erosion Control Notes and Details provided herein identify temporary and permanent stabilization measures to be employed with respect to specific elements of the project, and at the various stages of development.
  - Site map / construction drawing: This plan serves to satisfy this SWPPP requirement.
  - The dimensions, material specifications, installation details, and operation and maintenance requirements for all erosion and sediment control practices: The details, Erosion and Sediment Control Notes, and Erosion and Sediment Control Maintenance Schedule serve to satisfy this SWPPP requirement.
  - An inspection schedule: Inspections are to be performed twice weekly and by a qualified professional as required by the General Permit (GP-0-20-001). In addition the NYSDEC Trained Contractor shall perform additional inspections as cited in the Sedimentation and Erosion Control Notes.
  - A description of pollution prevention measures that will be used to control litter, construction chemicals and construction debris: In general, all construction litter / debris shall be collected and removed from the site. The general contractor shall supply either waste barrels or dumpster for proper waste disposal. Any construction chemicals utilized during construction shall either be removed from site daily by the contractor or stored in a structurally sound and weatherproof building. No hazardous waste shall be disposed of onsite, and shall ultimately be disposed of in accordance with all federal, state and local regulations. Material Safety Data Sheets (MSDS), material inventory, and emergency contact numbers shall be maintained by the general contractor for all construction chemicals utilized onsite. Finally, temporary sanitary facilities (portable toilets) shall be provided onsite during the entire length of construction, and inspected weekly for evidence of leaking holding tanks.
  - A description and location of any stormwater discharges associated with industrial activity other than construction at the site: There are no known industrial stormwater discharges present or proposed at the site.
  - Identification of any elements of the design that are not in conformance with the technical standard, "New York Standards and Specifications for Erosion and Sediment Control." All proposed elements of this SWPPP have been designed in accordance with the "New York Standards and Specifications for Erosion and Sediment Control."

**REQUIRED POST-CONSTRUCTION STORMWATER MANAGEMENT PRACTICE COMPONENTS:**

- Pursuant to the NYSDEC "SPDES General Permit for Stormwater Discharges from Construction Activity" (GP-0-20-001), all construction projects needing post-construction stormwater management practices shall prepare a SWPPP that also includes practices designed in conformance with the most current version of the technical standard, "New York State Stormwater Management Design Manual ("Design Manual"). Where post-construction stormwater management practices are not designed in conformance with this technical standard, the owner or operator must demonstrate equivalence to the technical standard. The following list of SWPPP components is provided in accordance with Part III.B.2.a-d and III.B.3:

  - Identification of all post-construction stormwater management practices to be constructed as part of the project; This plan, and details/notes shown hereon serve to satisfy this SWPPP requirement.
  - A site map/construction drawing(s) showing the specific location and size of each post-construction stormwater management practice; This plan, and details/notes shown hereon serve to satisfy this SWPPP requirement.
  - A Stormwater Modeling and Analysis Report including pre-development conditions, post-development conditions, the results of the stormwater modeling, a summary table demonstrating that each practice has been designed in conformance with the sizing criteria, identification of and justification for any deviations from the Design Manual, and identification of any design criteria that are not required. The required analysis is provided in the report titled Stormwater Pollution Prevention Plan for 1 Croton Point.
  - An operations and maintenance plan that includes inspection and maintenance schedules and actions to ensure continuous and effective operation of each post-construction stormwater management practice. The plan shall identify the entity that will be responsible for the long term operation and maintenance of each practice. The Permanent Stormwater Facilities Maintenance Schedule provided on these plans serves to satisfy this requirement.

- Enhanced Phosphorus Removal Standards - Beginning on September 30, 2008, all construction projects identified in Table 2 of Appendix B that are located in the watersheds identified in Appendix C shall prepare a SWPPP that includes post-construction stormwater management practices designed in conformance with the Enhanced Phosphorus Removal Standards included in the most current version of the technical standard, "New York Stormwater Management Design Manual." At a minimum, the post-construction stormwater management practice component of the SWPPP shall include items 2.a - 2.f above. This requirement is not applicable as the project is not located in the watersheds identified in Appendix C.

**EROSION AND SEDIMENT CONTROL MAINTENANCE SCHEDULE**

PRACTICE	MONITORING REQUIREMENTS			MAINTENANCE REQUIREMENTS	
	DAILY	WEEKLY	AFTER RAINFALL	DURING CONSTRUCTION	AFTER CONSTRUCTION
SILT FENCE BARRIER	-	Inspect	Inspect	Clean/Replace	Remove
STABILIZED CONSTRUCTION ENTRANCE	Inspect	-	Inspect	Clean/Replace Stone and Fabric	Remove
INLET PROTECTION	-	Inspect	Inspect	Clean/Repair/Replace	Remove
DUST CONTROL	Inspect	-	Inspect	Mulching/Spraying Water	N/A
*VEGETATIVE ESTABLISHMENT	-	Inspect	Inspect	Water/Reseed/Retain	Reseed to 80% Coverage
SOIL STOCKPILES	-	Inspect	Inspect	Mulching/Silt Fence Repair	Remove
SWALES	-	Inspect	Inspect	Clean/Mulch/Repair	Mow Permanent Grass/Replace/Repair Rip Rap
CONCRETE DRAINAGE STRUCTURES	-	Inspect	Inspect	Clean Sumps/Remove Debris/Repair/Replace	See Permanent Stormwater Facilities Maintenance Schedule on Drawing D-10
DRAINAGE PIPES	-	Inspect	Inspect	Clean/Repair	See Permanent Stormwater Facilities Maintenance Schedule on Drawing D-10
ACCESS ROAD / PAVEMENT	-	Inspect	Inspect	Clean	Clean
HYDROPHAMIC SEPARATOR	-	Inspect	Inspect	Clean per Manufacturer Specification	See Permanent Stormwater Facilities Maintenance Schedule on Drawing D-10

\* Permanent vegetation is considered stabilized when 80% of the plant density is established. Erosion control measures shall remain in place until all disturbed areas are permanently stabilized.

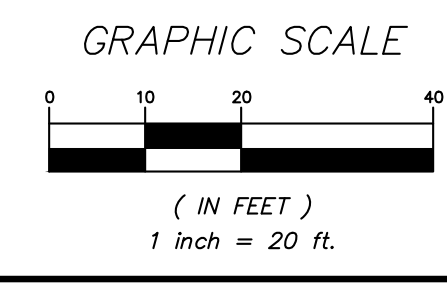

NO.	DATE	REVISION	BY
<b>PROJECT:</b> <b>1 CROTON POINT</b> CROTON POINT AVE. & VETERANS PLAZA, VILLAGE OF CROTON-ON-HUDSON, WESTCHESTER CO., NY			
<b>DRAWING:</b> <b>EROSION &amp; SEDIMENT CONTROLS PLAN</b>			
PROJECT NUMBER	24154.100	PROJECT MANAGER	R.D.W.
DATE	7-11-24	DRAWN BY	M.E.U.
SCALE	1" = 20'	CHECKED BY	D.L.M.
DRAWING NO.	SHEET		
SP-3	5		7

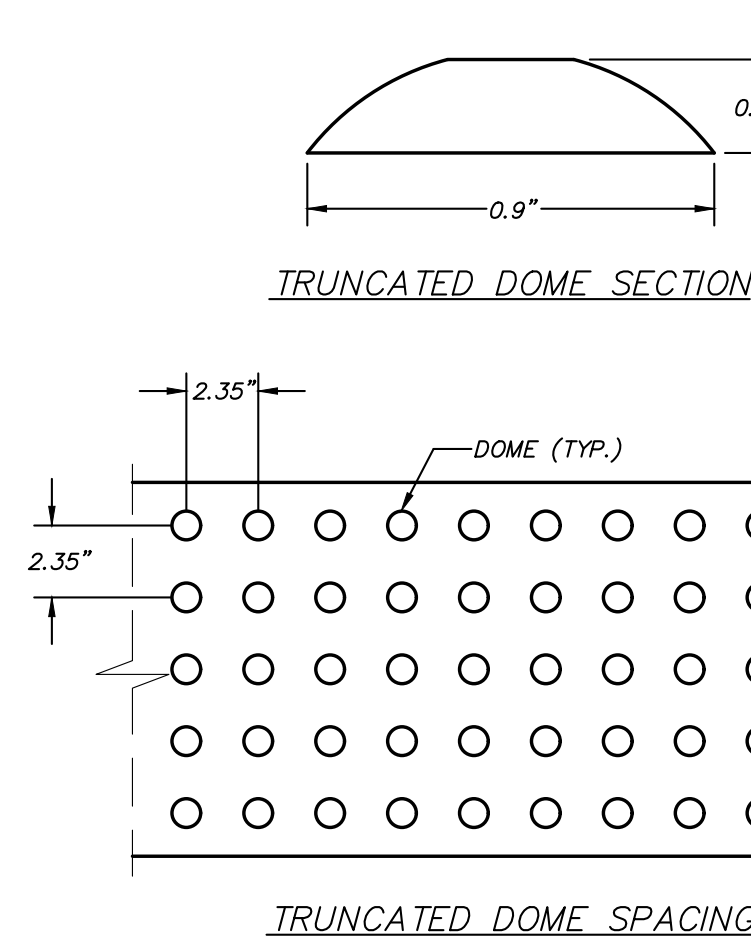
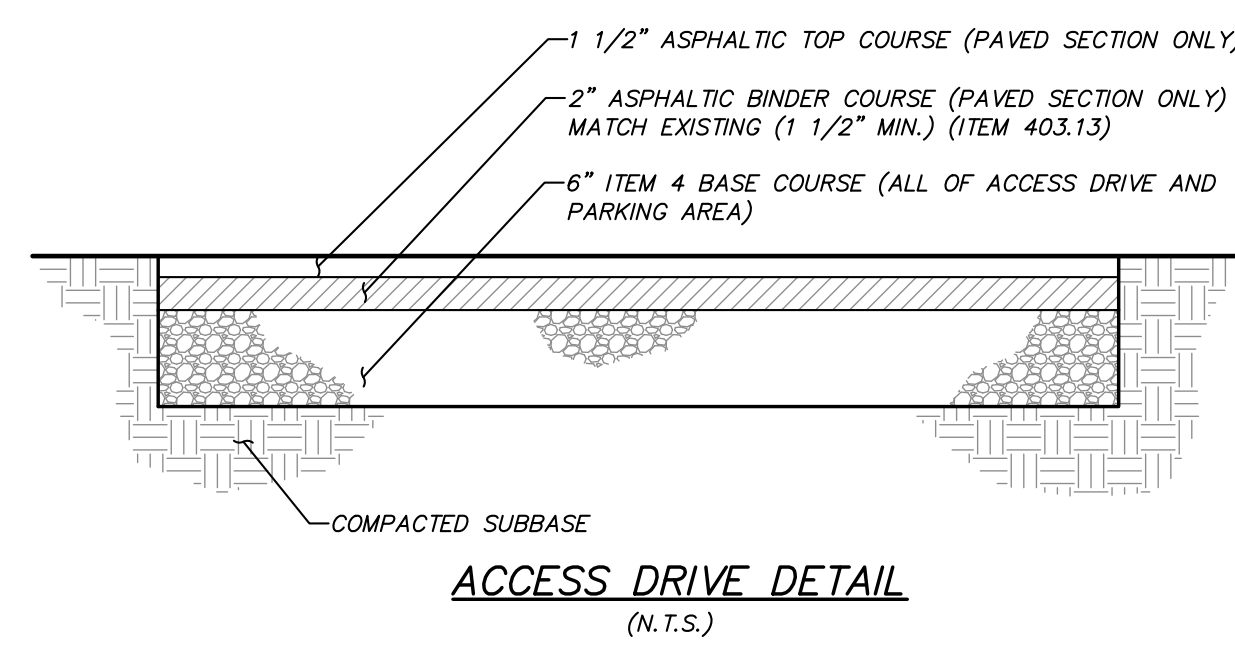

**NOTES:**

- The detectable warning field shall consist of raised truncated domes with a nominal diameter of 0.9 inches, a nominal height of 0.2 inches, and a nominal spacing of 2.35 inches on center in accordance with the Department of Justice-Code of Federal Regulations, 28 CFR Part 36, Existing 4 "ADA Standards for Accessible Design", revised as of July 1, 1994.
- The details provided are not drawn to scale. The quantity of domes depicted on the detectable warning field (the domes and the entire 24 inch level surface) is for illustration only.
- The size of the detectable warning field shall be 24 inches in the direction of travel and shall extend the full width of the curb ramp or flush surface, exclusive of side flares.
- Detectable warnings shall be located so that the edge of the warning field nearest to the roadway or street surface is 6 inches to 8 inches from the edge of the roadway/street, or from the front of the dropped curb, where a dropped curb continues across the bottom of the sidewalk curb ramp.
- Domes shall be aligned on a square grid in the predominant direction of travel.
- The detectable warning field shall be the color specified in the contract documents. Detectable warning surfaces shall contrast visually with adjacent gutter, street, highway, or pedestrian access route surface, either light-on-dark or dark-on-light.
- Payment lines are the 24 inch dimension shown in the details extending the full width of the curb ramp and/or applicable surfaces.
- Provide a broom finish, flush to adjacent sidewalk/curb, on all areas to receive the detectable warning fields.

**PAINTED NYS ACCESSIBLE PARKING DETAIL (N.T.S.)**

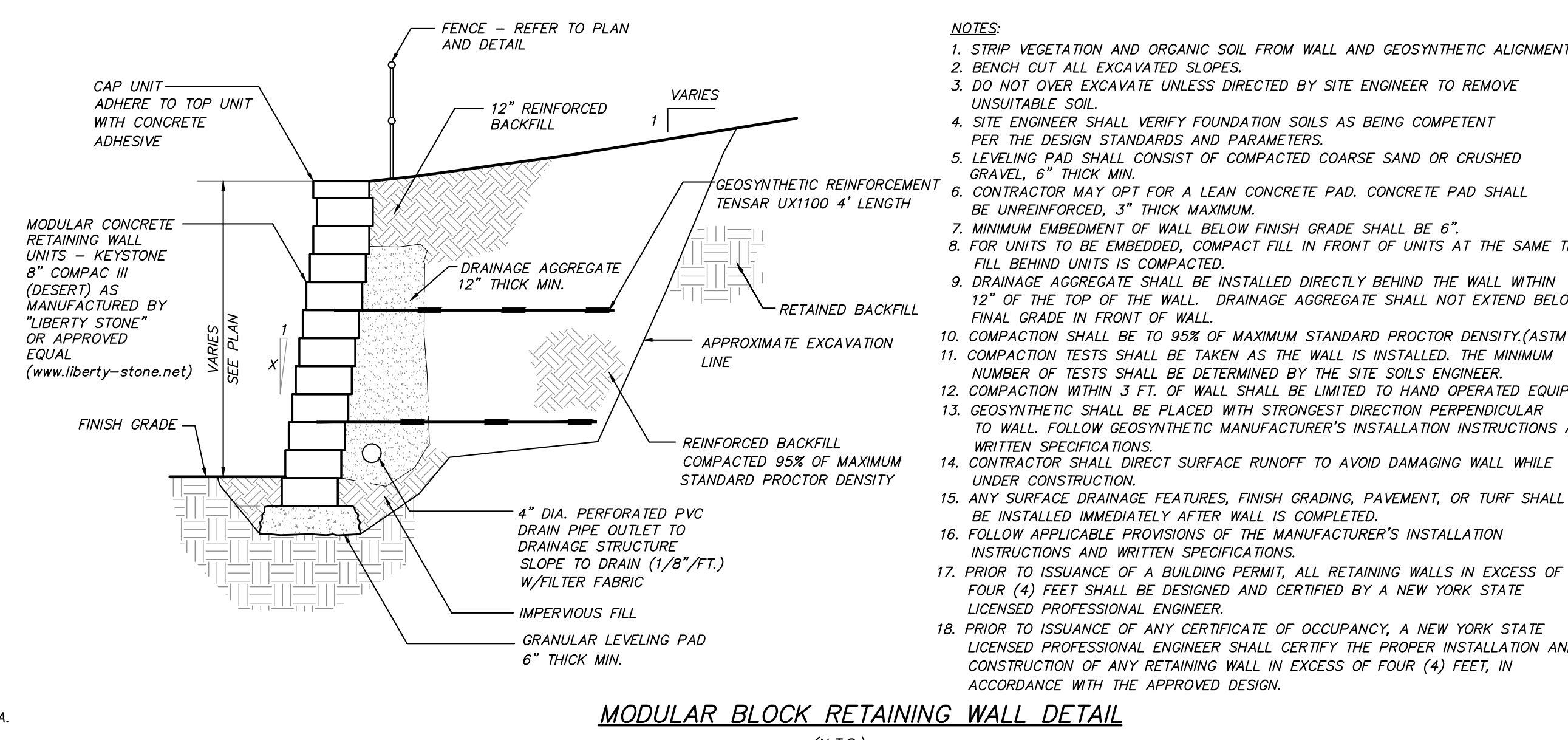
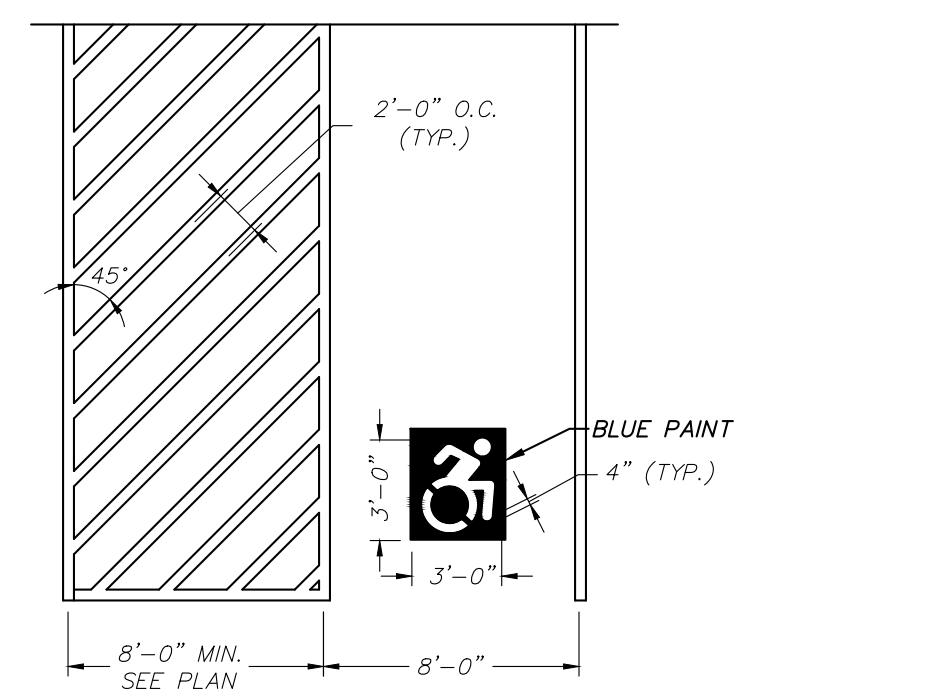

- NOTES:**
- STRIP VEGETATION AND ORGANIC SOIL FROM WALL AND GEOSYNTHETIC ALIGNMENT.
  - BENCH OUT ALL EXCAVATED SLOPES.
  - DO NOT OVER EXCAVATE UNLESS DIRECTED BY SITE ENGINEER TO REMOVE UNSUITABLE SOIL.
  - SITE ENGINEER SHALL VERIFY FOUNDATION SOILS AS BEING COMPETENT PER THE DESIGN STANDARDS AND PARAMETERS.
  - LEVELING PAD SHALL CONSIST OF COMPACTED COARSE SAND OR CRUSHED GRAVEL, 6" THICK MIN.
  - CONTRACTOR MAY OPT FOR A LEAN CONCRETE PAD. CONCRETE PAD SHALL BE UNREINFORCED, 3" THICK MAXIMUM.
  - MINIMUM EMBEDMENT OF WALL BELOW FINISH GRADE SHALL BE 6".
  - FOR UNITS TO BE EMBEDDED, COMPACT FILL IN FRONT OF UNITS AT THE SAME TIME FILL BEHIND UNITS IS COMPACTED.
  - DRAINAGE AGGREGATE SHALL BE INSTALLED DIRECTLY BEHIND THE WALL WITHIN 12" OF THE TOP OF THE WALL. DRAINAGE AGGREGATE SHALL NOT EXTEND BELOW FINAL GRADE IN FRONT OF WALL.
  - COMPACTION SHALL BE TO 95% OF MAXIMUM STANDARD PROCTOR DENSITY (ASTM D-698) NUMBER OF TESTS SHALL BE DETERMINED BY THE SITE SOILS ENGINEER.
  - CONSTRUCTION WITHIN 3 FT. OF WALL SHALL BE LIMITED TO HAND OPERATED EQUIPMENT.
  - GEOSYNTHETIC SHALL BE PLACED WITH STRONGEST DIRECTION PERPENDICULAR TO WALL. FOLLOW GEOSYNTHETIC MANUFACTURER'S INSTALLATION INSTRUCTIONS AND WRITTEN SPECIFICATIONS.
  - CONTRACTOR SHALL DIRECT SURFACE FINISH TO AVOID DAMAGING WALL AND UNDER CONSTRUCTION.
  - ANY SURFACE DRAINAGE FEATURES, FINISH GRADING, PAVEMENT, OR TURF SHALL BE INSTALLED IMMEDIATELY AFTER WALL IS COMPLETED.
  - FOLLOW APPLICABLE PROVISIONS OF THE MANUFACTURER'S INSTALLATION INSTRUCTIONS AND WRITTEN SPECIFICATIONS.
  - PRIOR TO ISSUANCE OF A BUILDING PERMIT, ALL RETAINING WALLS IN EXCESS OF FOUR (4) FEET SHALL BE DESIGNED AND CERTIFIED BY A NEW YORK STATE LICENSED PROFESSIONAL ENGINEER.
  - PRIOR TO ISSUANCE OF ANY CERTIFICATE OF OCCUPANCY, A NEW YORK STATE LICENSED PROFESSIONAL ENGINEER SHALL CERTIFY THE PROPER INSTALLATION AND CONSTRUCTION OF ANY RETAINING WALL IN EXCESS OF FOUR (4) FEET, IN ACCORDANCE WITH THE APPROVED DESIGN.

**MODULAR BLOCK RETAINING WALL DETAIL (N.T.S.)**

**GENERAL NOTES FOR ACCESSIBLE ROUTES:**

- Accessible routes to and within a site shall be provided from accessible building entrances to accessible pedestrian walkways, accessible facilities, accessible site elements and spaces, accessible parking spaces, access aisles, passenger loading zones, and to the public way, including public transportation stops, public streets and sidewalks.
- These sheets are in accordance with the Americans with Disabilities Act (ADA) and the NYS Building Code for Site Accessibility. The slope of floor surfaces is measured parallel to the curb line.
- Dimensions shown in the details as minimums and maximums are the limits for design and field layout. Facilities shall not be constructed with values outside the limits for work acceptance. See table "Design Element Tolerances" on this sheet.
- To check field layout and to verify work acceptance, all slopes and grades will be measured with a 4' long digital level using at least two readings. Where the readings vary, the measurements will be averaged. Grade (running slope) will be measured along the centerline and offset 1' to 1'-6" from the centerline. Cross slopes will be measured perpendicular to centerline at 5' to 10' intervals.
- Grade (running slopes) are measured in the direction of pedestrian travel. Cross slopes are measured perpendicular to the direction of pedestrian travel.
- Joints between sidewalks, curbs, turning spaces and roadways shall be flush and free from abrupt vertical changes greater than 1/4". Vertical surface discontinuities between 1/4" and 1/2" shall be beveled with a slope not steeper than 1V:2H. The bevel shall be applied across the entire joint.
- Sidewalks are connected to roadways by either blended transitions or curb ramps. Blended transitions are provided between the sidewalk level and the roadway level that have a maximum grade (running slope) of 5.0%, and transitions greater than 5.0% are considered curb ramps.
- Curb ramps and blended transitions may require the installation of detectable warnings. See additional "Detectable Warning" notes on this sheet, and sidewalk and curb ramp details included in the site plan set.
- Vertical alignment shall be generally planar. Grade breaks within the pedestrian access route shall be perpendicular to the direction of travel and shall not be rounded.
- Sidewalk grade (running slope) shall not exceed 4.5% for design and layout, except when matching to existing sidewalk or when the highway grade is steeper. When adjacent road grade is greater than 5.0%, the sidewalk grade shall not exceed the adjacent road grade.
- The cross slope of pedestrian access routes shall be 1.5% maximum for design and layout, and 2.0% maximum for work acceptance. The following exceptions are allowed:
  - Where pedestrian street crossings are provided at intersections without yield or stop control, or where there is any traffic signal without a flashing red, the cross slope of a pedestrian access route contained within a street crossing shall be 4.5% maximum for design and layout, and 5.0% maximum for work acceptance.
  - Where midblock pedestrian street crossings are provided, the cross slope of a pedestrian access route contained within a midblock street crossing shall be permitted to equal the street or highway grade.
- Marked Accessible Parking Spaces and Access Aisles:
  - Dimensions - accessible parking spaces shall be at least 8' wide and shall have an adjacent access aisle 8' wide measured perpendicular to the stall stripe to accommodate vans with lifts.
  - Common access aisles for 90° parking - two accessible parking spaces may share a common access aisle. For acute angled parking, such as 60° parking, or where one way driveway drives would prevent vans with passenger side lifts from backing into accessible spaces, an accessible access aisle must be provided for each accessible parking space, with access aisles and parking spaces are measured perpendicular to the striping.
  - Signage - each accessible parking space shall be marked by permanently installed signs which display the International Symbol of Access. Each access aisle shall be marked by permanently installed signs indicating that stopping is not permitted in the aisle. Signs shall not block the accessible clear width of adjacent walkways. Signs located where they may be hit by vehicles being parked shall be installed in a post base. The bottoms of the signs located on posts installed in paved areas shall be 7" minimum above the walkway surface. The bottoms of signs located in unpaved areas shall be 7" minimum above the pavement surface.
  - Surface slopes - slopes at accessible parking spaces, access aisles, and adjoining walkways shall be 1.5% maximum in any direction for design and layout, and 2.0% maximum for work acceptance, while providing positive drainage.
  - Overhead clearance - vehicle access routes to and from accessible parking spaces, including in garages and open parking structures, shall have a minimum vertical clearance of 8'-2".
  - Pavement marking colors - required accessible parking space and access aisle striping and other optional pavement markings, such as the International Symbol of Access, shall be painted white or blue.
  - A smooth, flush transition must be provided between all pedestrian walkways, accessible parking spaces and aisles.
  - Where a change in direction is required to access a curb ramp from an access aisle, a turning space 4'-0" x 4'-0" minimum shall be provided at the base of the top of curb ramp, as applicable. The cross slope of turning spaces shall not exceed 1.5% in any direction for design and layout, and 2.0% for work acceptance, while providing positive drainage.
  - Adjacent finished grades along sides of ramp and landings shall not have a vertical slope greater than 1:2" within 10' of the edge of the concrete. If the adjacent finished grades do not meet this criterion, a 4" minimum high curb shall be provided (see plan for location). If a curb is provided to adjacent grade is 2'-6" or greater, "curbs" will need to be provided to meet the requirements as specified in the NYS Building Code latest edition.
  - Refer to concrete handicap ramp detail for additional information.
- Walkways Along an Accessible Route:
  - Walking surfaces shall be stable, firm and slip resistant.
  - Vertical changes in level along walking surface shall not exceed 1/4".
  - Changes in level greater than 1/4" in height and not more than 1/2" shall be beveled with a slope not steeper than 1V:2H.
  - The running slope of the walking surface shall not be steeper than 4.5%.
  - The cross slope of a walking surface shall not be steeper than 1.5%.
  - The clear width of an accessible route shall be 5'-0" minimum.
  - An accessible route with a clear width less than 5'-0" shall provide passing spaces at intervals of 200' maximum. Passing spaces shall be 5'-0" minimum by 5'-0" minimum.
- Ramps along an accessible route:
  - Ramp runs shall have a running slope greater than 5.0%.
  - Ramp runs shall have a running slope of 7.5% maximum for design and layout, and 8.3% maximum for work acceptance.
  - The cross slope of ramp runs shall not exceed 1.5% for design and layout, and 2.0% maximum for work acceptance.
  - Walking surfaces of ramp runs and associated landings shall be stable, firm and slip resistant.
  - The clear width of a ramp run shall be 3'-0" minimum or as shown. Handrails and handrail supports provided on the ramp run shall not project into the required clear width of the ramp run or associated landing.
  - The maximum rise for any ramp is 2'-8".
  - The maximum run for any ramp is 30'-0".
  - Ramps shall have landings at the bottom and top of each ramp run. Landings shall have a slope not to exceed 1.5% for design and layout, and 2.0% maximum for work acceptance, while providing positive drainage. Landings shall have a clear length and width of 5'-0" minimum.
  - Adjacent finished grades along sides of ramp and landings shall not have a vertical slope greater than 1:2" within 10' of the edge of the concrete. If the adjacent finished grades do not meet this criterion, a 4" minimum high curb shall be provided (see plan for location). If a curb is provided to adjacent grade is 2'-6" or greater, "curbs" will need to be provided to meet the requirements as specified in the NYS Building Code latest edition.
  - Refer to concrete handicap ramp detail for additional information.
- For access to and within refuge enclosures, refer to the Refuge Enclosure Detail.

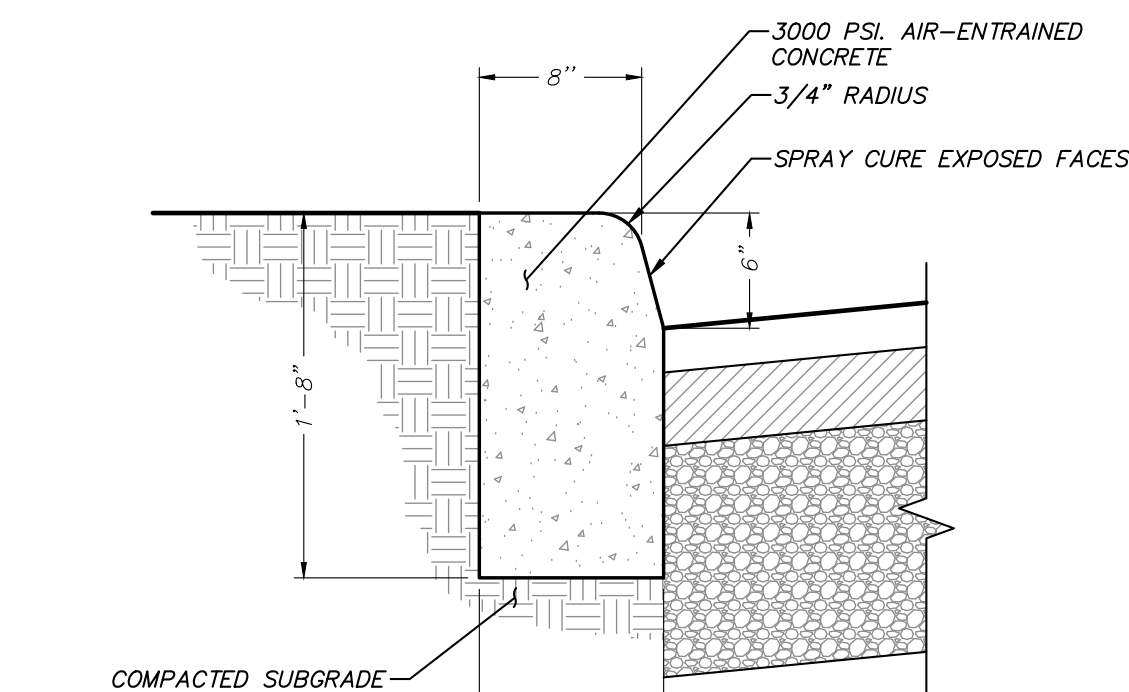

**CONCRETE CURB DETAIL (N.T.S.)**

SIGN DATA TABLE				
LOCATION NO.	TEXT	M.U.T.C.D. NUMBER	SIZE OF SIGN (s.f.)	DESCRIPTION
1		R7-1	12" x 18"	Red on White
2		NY R7-8*	12" x 18"	Green on White Blue Symbol
		R7-BP	12" x 6"	Green on White
3		R5-1C	30" x 30"	White on Red

\* NOTE: New NYS Handicap symbol recognized only by NYS

NOTE: TRANSVERSE JOINTS 1/2" WIDE SHALL BE INSTALLED IN THE CURB 10'-0" APART AND SHALL BE FILLED WITH CELLULAR COMPRESSION MATERIALS AS SPECIFIED, RECESSED 1/4" IN FROM FRONT FACE AND TOP OF CURB.

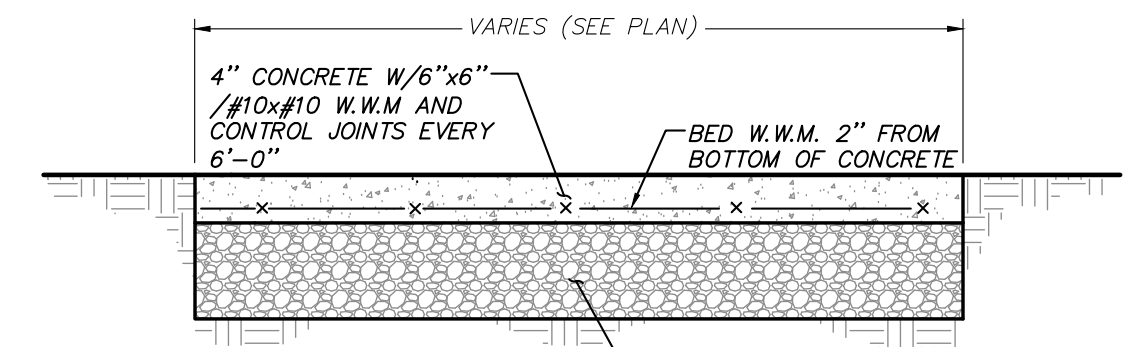

**CONCRETE SIDEWALK DETAIL (N.T.S.)**

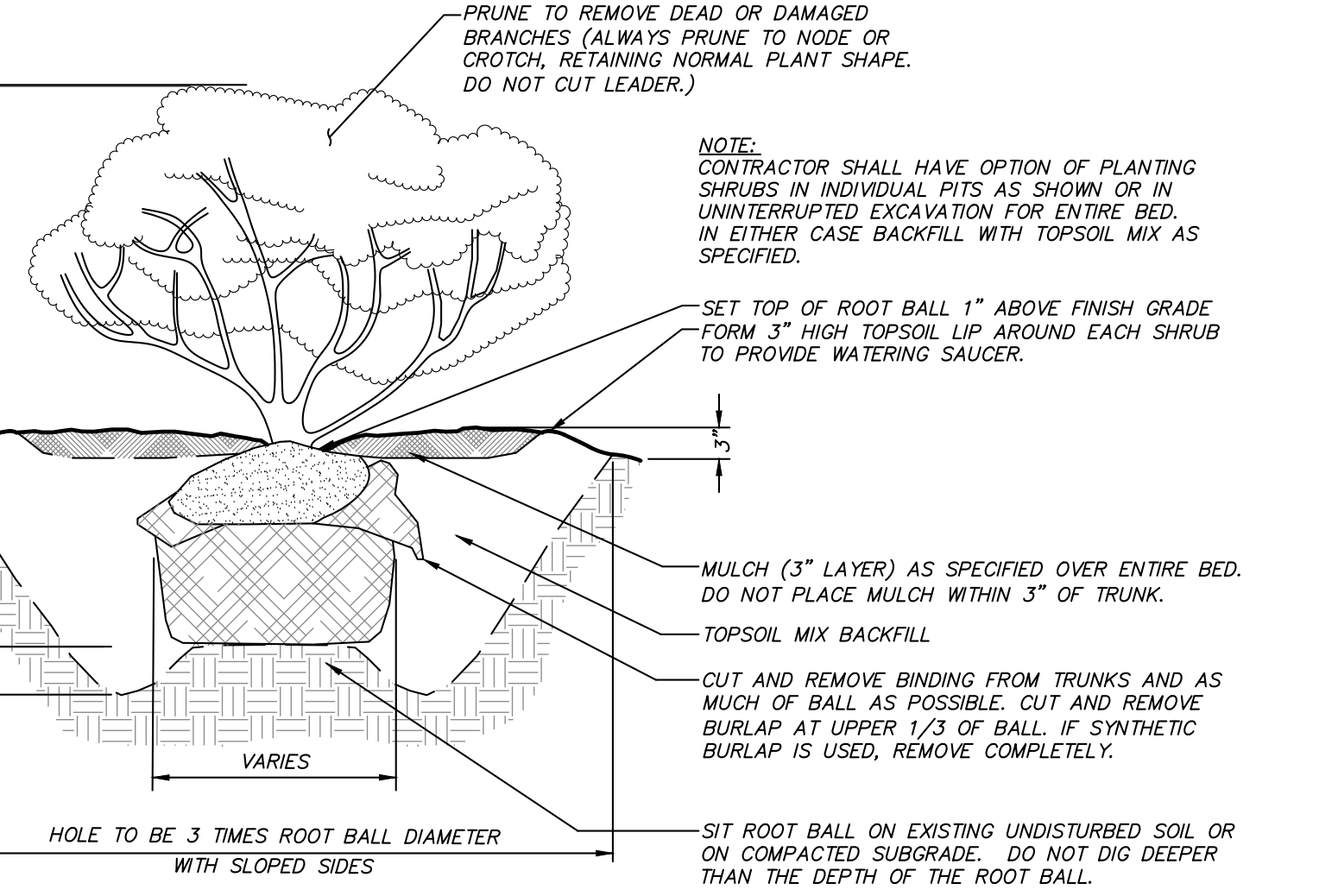

**SHRUB PLANTING DETAIL (N.T.S.)**

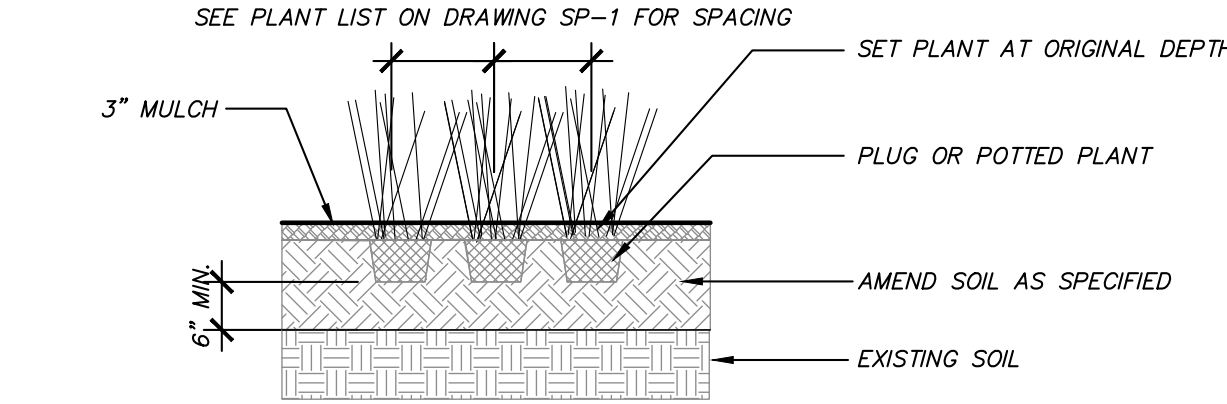

**PERENNIAL / ORNAMENTAL GRASS PLANTING DETAIL (N.T.S.)**

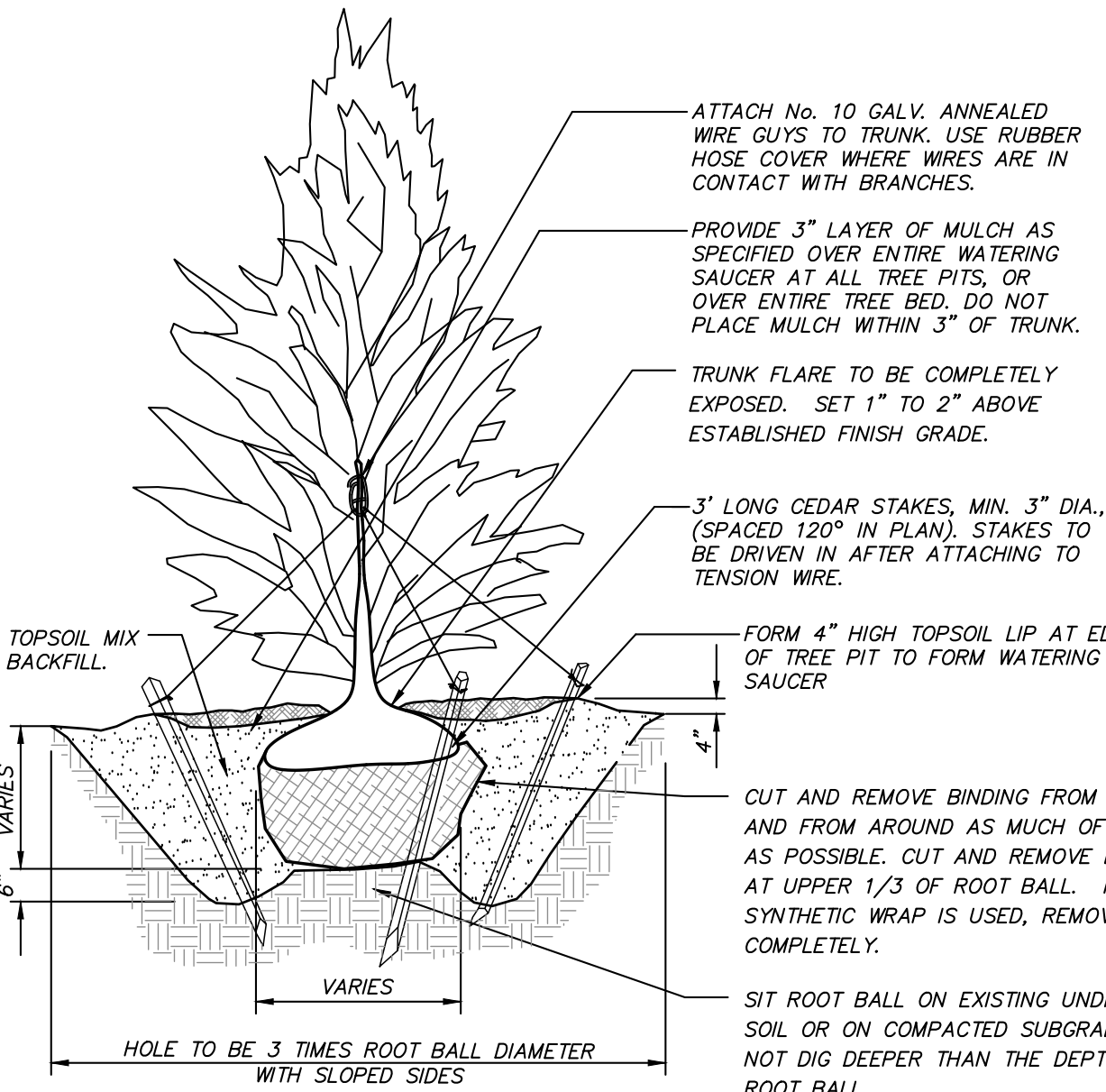

**EVERGREEN TREE PLANTING DETAIL (N.T.S.)**

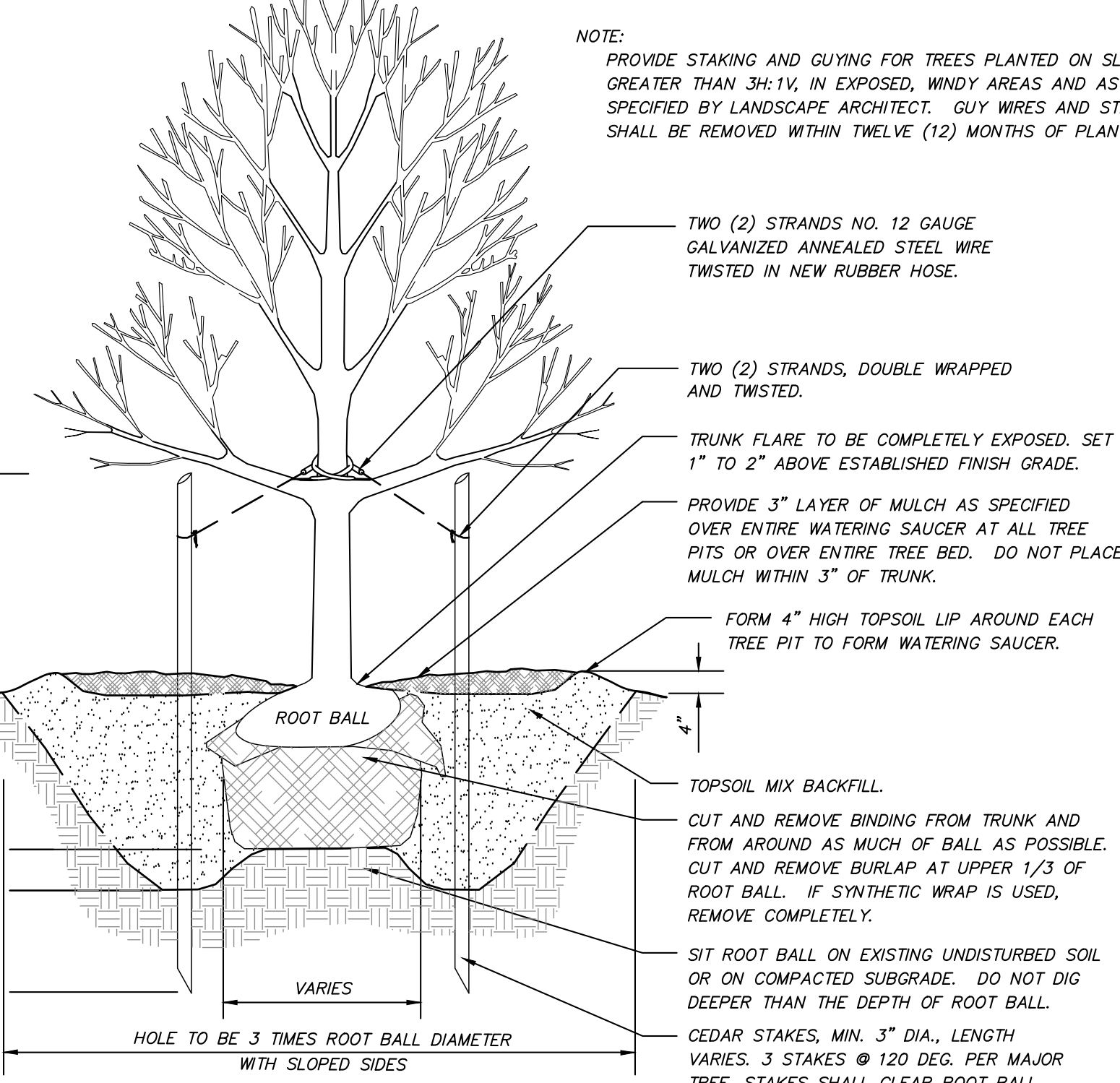

**TREE PLANTING DETAIL (N.T.S.)**

NOTE: PROVIDE STAKING AND GUYING FOR TREES PLANTED ON SLOPES GREATER THAN 3H:1V, IN EXPOSED, WINDY AREAS AND AS SPECIFIED BY LANDSCAPE ARCHITECT. GUY WIRES AND STAKES SHALL BE REMOVED WITHIN TWELVE (12) MONTHS OF PLANTING.

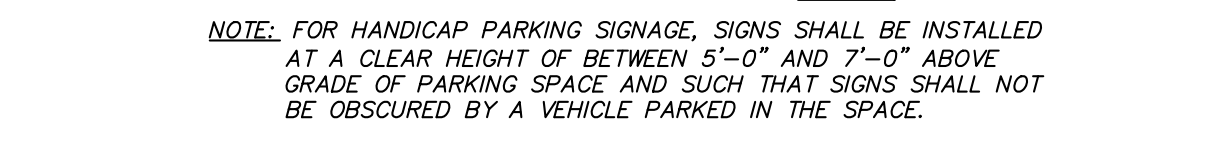

**TRAFFIC SIGN DETAIL (N.T.S.)**

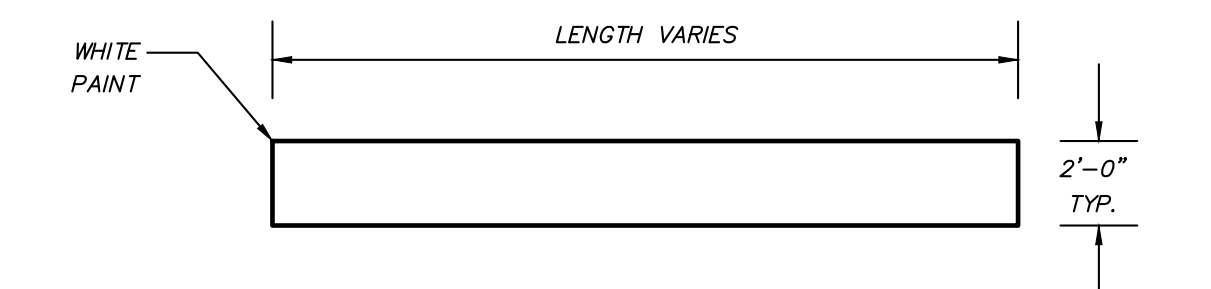

**PAINTED STOP BAR DETAIL (N.T.S.)**

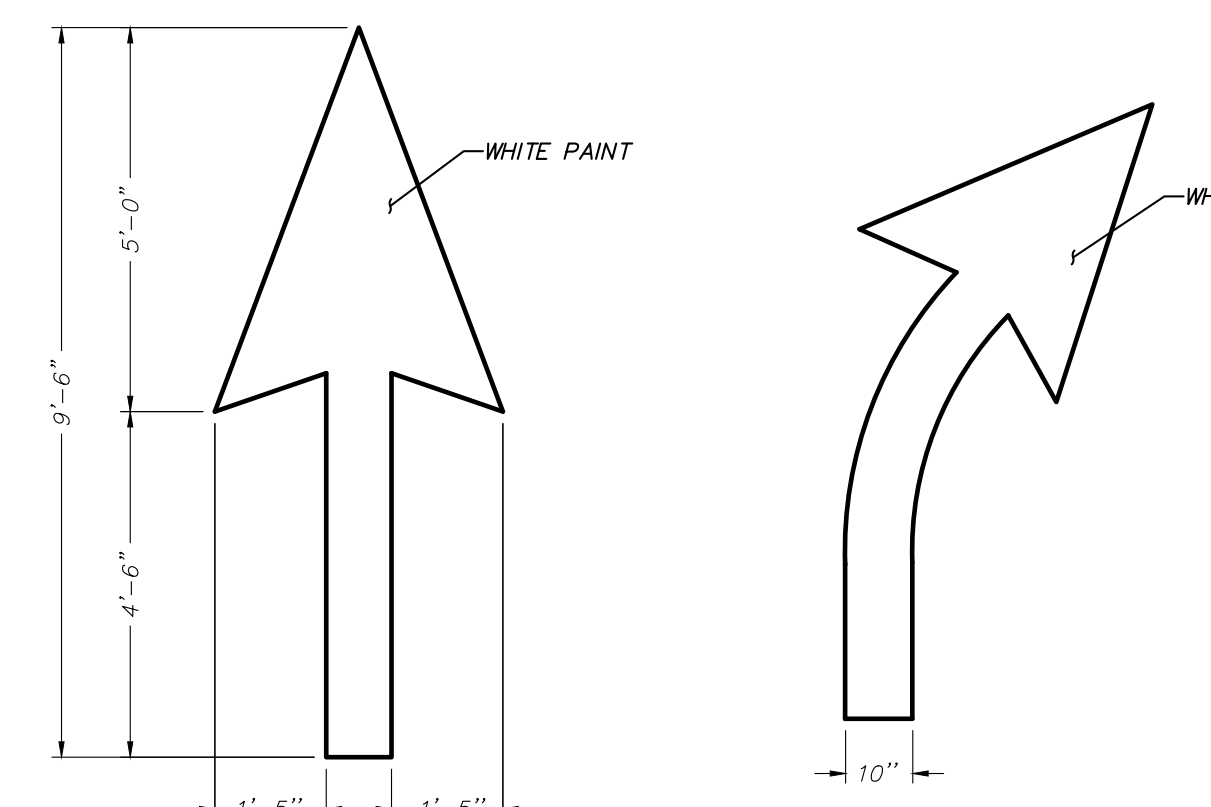

**DIRECTIONAL ARROWS DETAIL (N.T.S.)**

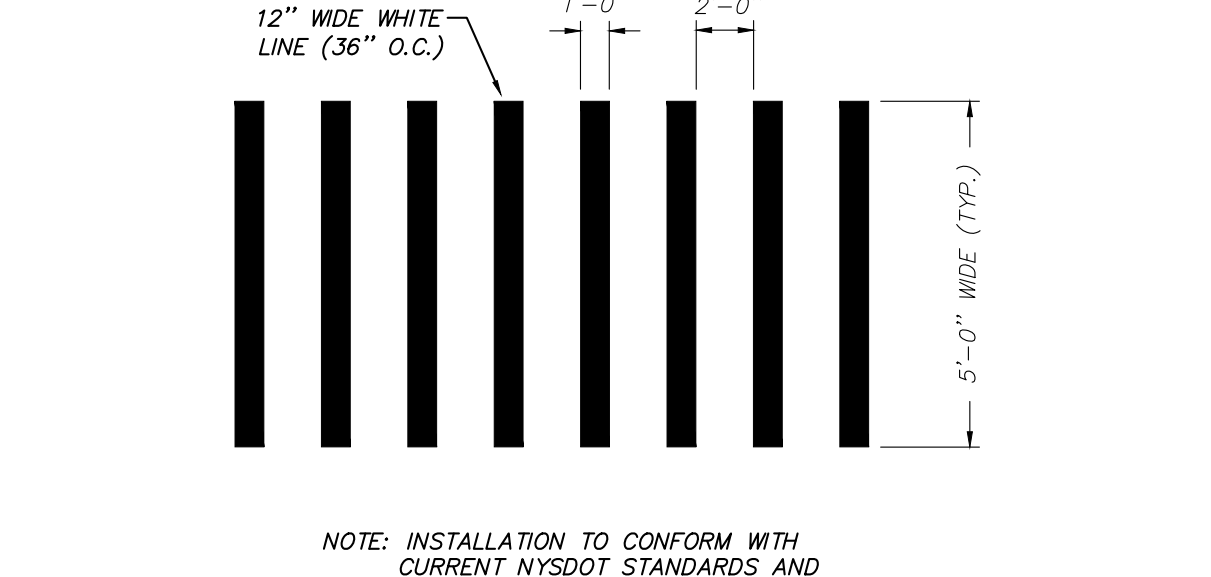

**CROSSWALK MARKING DETAIL (TYPE 2) (N.T.S.)**

NO.	DATE	REVISION	BY

**INSITE**  
ENGINEERING, SURVEYING & LANDSCAPE ARCHITECTURE, P.C.

PROJECT: **1 CROTON POINT**  
CROTON POINT AVE. & VETERANS PLAZA, VILLAGE OF CROTON-ON-HUDSON, WESTCHESTER CO., NY

DRAWING: **DETAILS**

PROJECT NUMBER	DATE	SCALE	PROJECT MANAGER	CHECKED BY	R.D.W.	M.E.U.	D.L.M.	DRAWING NO.	SHEET
24154.100	7-11-24	AS SHOWN						D-1	6



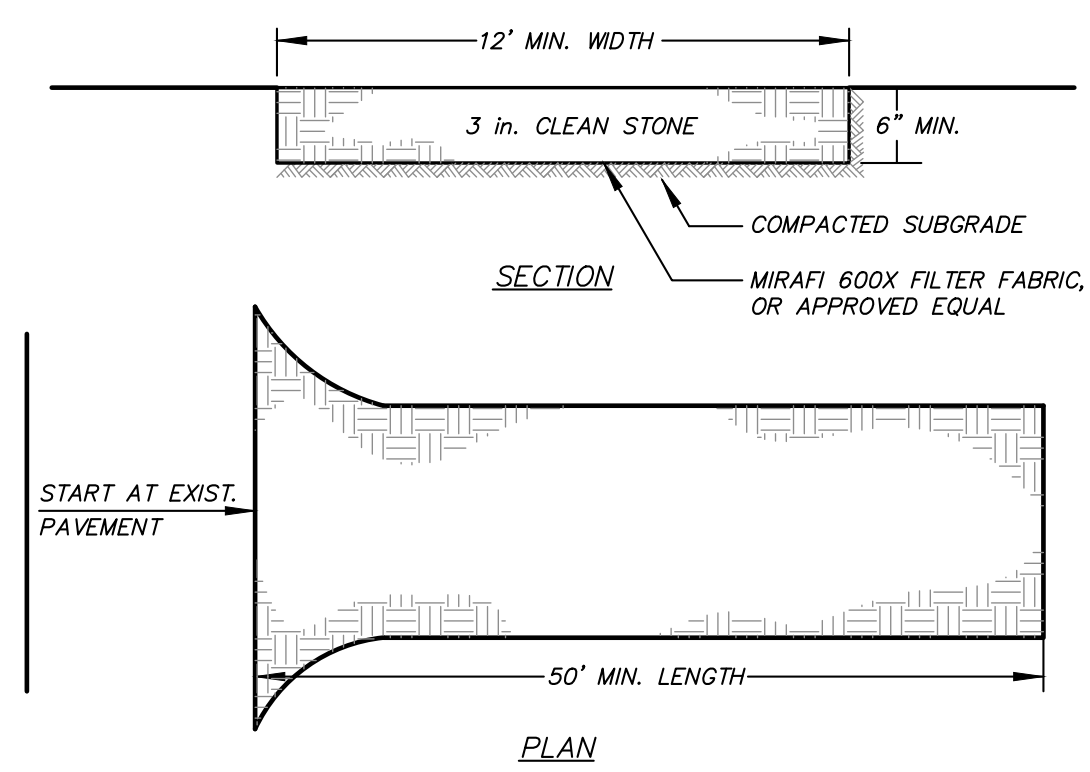

**INSTALLATION NOTES**

- STONE SIZE - USE 3" STONE
- LENGTH - AS REQUIRED, BUT NOT LESS THAN 50 FEET EXCEPT ON A SINGLE RESIDENCE LOT WHERE A 30 FOOT MINIMUM LENGTH WOULD APPLY
- THICKNESS - NOT LESS THAN SIX (6) INCHES
- WIDTH - 12 FOOT MINIMUM, BUT NOT LESS THAN THE FULL WIDTH AT POINTS WHERE INGRESS OR EGRESS OCCUR. TWENTY FOUR (24) FOOT IF SINGLE ACCESS TO SITE.
- FILTER CLOTH - WILL BE PLACED OVER THE ENTIRE AREA PRIOR TO PLACING OF STONE. FILTER CLOTH WILL NOT BE REQUIRED ON A SINGLE FAMILY RESIDENCE LOT.
- SURFACE WATER - ALL SURFACE WATER FLOWING OR DIVERTED TOWARD CONSTRUCTION ENTRANCES SHALL BE PIPED ACROSS THE ENTRANCE. IF PIPING IS IMPRACTICAL, A MOUNTABLE BERM WITH 5:1 SLOPES WILL BE PERMITTED.
- MAINTENANCE - THE ENTRANCE SHALL BE MAINTAINED IN A CONDITION WHICH WILL PREVENT TRACKING OR FLOWING OF SEDIMENT ONTO PUBLIC RIGHT OF WAY. THIS MAY REQUIRE PERIODIC TOP DRESSING WITH ADDITIONAL STONE AS CONDITIONS DEMAND AND REPAIR AND/OR CLEANOUT OF ANY MEASURES USED TO TRAP SEDIMENT. ALL SEDIMENT SPILLED, DROPPED, WASHED OR TRACKED ONTO PUBLIC RIGHT OF WAY MUST BE REMOVED IMMEDIATELY.
- WASHING - WHEELS SHALL BE CLEANED TO REMOVE SEDIMENT PRIOR TO ENTRANCE ONTO PUBLIC RIGHT OF WAY. WHEN WASHING IS REQUIRED, IT SHALL BE DONE ON AN AREA STABILIZED WITH STONE AND WHICH DRAINS INTO AN APPROVED SEDIMENT TRAPPING DEVICE.
- PERIODIC INSPECTION AND NEEDED MAINTENANCE SHALL BE PROVIDED AFTER EACH RAIN.

**STABILIZED CONSTRUCTION ACCESS DETAIL (N.T.S.)**

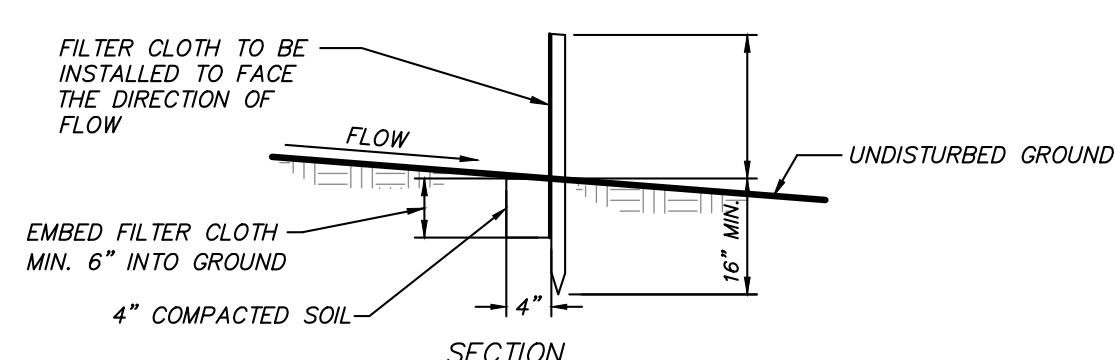
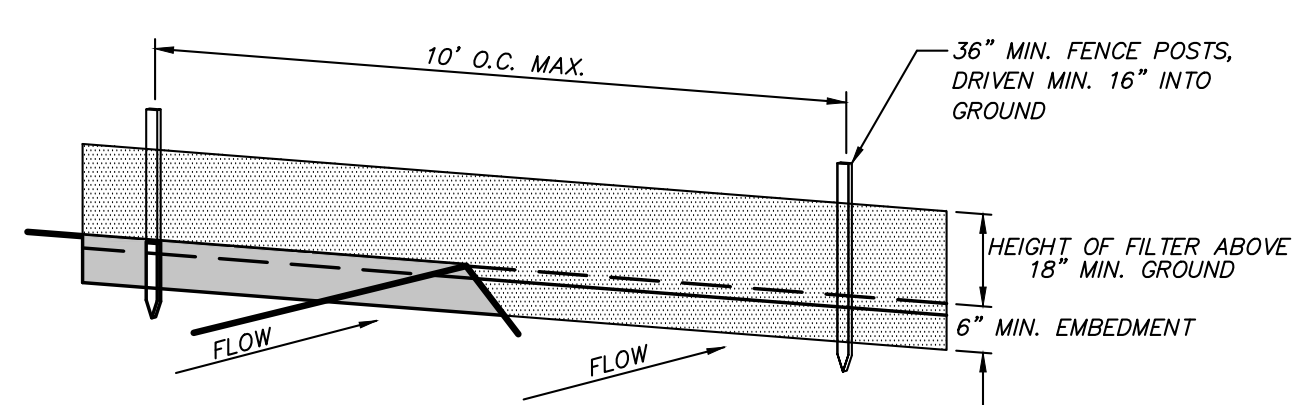

- CONSTRUCTION NOTES FOR FABRICATED SILT FENCE**
- WOVEN WIRE FENCE TO BE FASTENED SECURELY TO FENCE POSTS WITH WIRE TIES OR STAPLES. POSTS SHALL BE STEEL EITHER "T" OR "U" TYPE OR HARDWOOD.
  - FILTER CLOTH TO BE TO BE FASTENED SECURELY TO WOVEN WIRE FENCE WITH TIES SPACED EVERY 24" AT TOP AND MID SECTION. FENCE SHALL BE WOVEN WIRE, 6" MAXIMUM MESH OPENING.
  - WHEN TWO SECTIONS OF FILTER CLOTH ADJOIN, EACH OTHER THEY SHALL BE OVERLAPPED BY SIX INCHES AND FOLDED. FILTER CLOTH SHALL BE EITHER FILTER X, MIRAFIX 100X, STABILINKA T140N, OR APPROVED EQUIVALENT.
  - PREFABRICATED UNITS SHALL BE GEOTAB, ENVIROFENCE, OR APPROVED EQUIVALENT.
  - MAINTENANCE SHALL BE PERFORMED AS NEEDED AND MATERIAL REMOVED WHEN "BULGES" DEVELOP IN THE SILT FENCE.

**STANDARD SILT FENCE DETAIL (N.T.S.)**

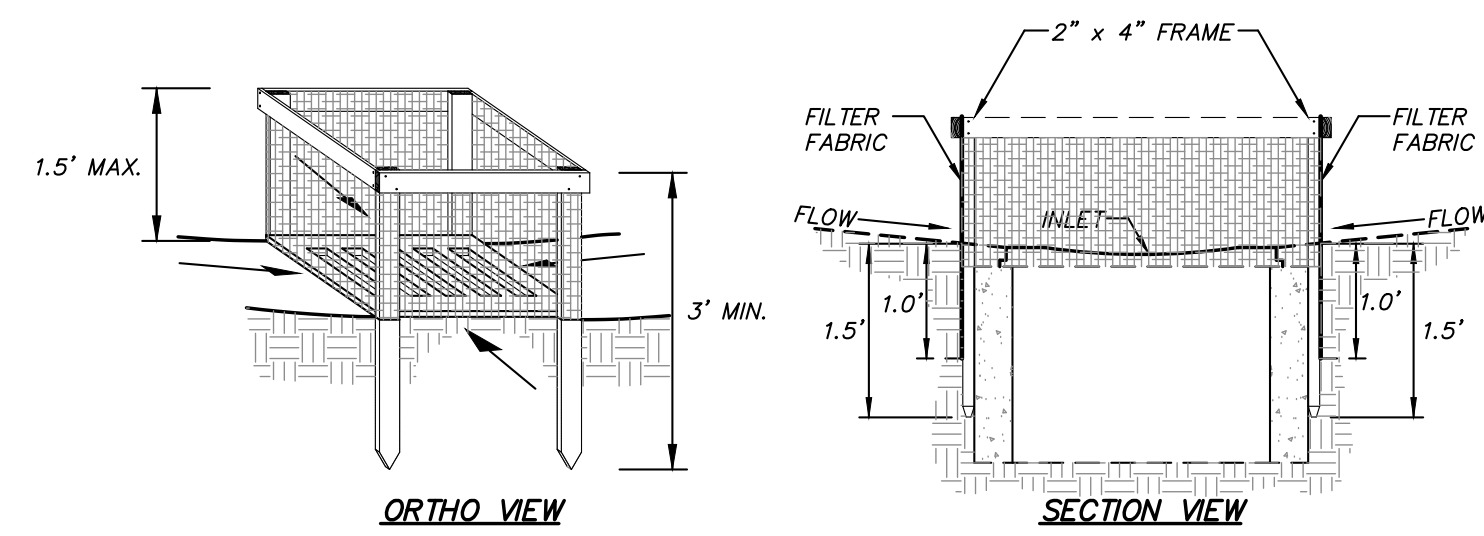

**INSTALLATION NOTES**

- FILTER FABRIC SHALL HAVE AN EOS OF 40-85. BURLAP MAY BE USED FOR SHORT TERM APPLICATIONS.
- CUT FABRIC FROM A CONTINUOUS ROLL TO ELIMINATE JOINTS. IF JOINTS ARE NEEDED THEY WILL BE OVERLAPPED TO THE NEXT STAKE.
- STAKE MATERIALS WILL BE STANDARD 2" x 4" WOOD OR EQUIVALENT. METAL WITH A MINIMUM LENGTH OF 3 FEET.
- SPACE STAKES EVENLY AROUND INLET 3 FEET APART AND DRIVE A MINIMUM 18 INCHES DEEP. SPANS GREATER THAN 3 FEET MAY BE BRIDGED WITH THE USE OF WIRE MESH BEHIND THE FILTER FABRIC FOR SUPPORT.
- FABRIC SHALL BE EMBEDDED 1 FOOT MINIMUM BELOW GROUND AND BACKFILLED. IT SHALL BE SECURELY FASTENED TO THE STAKES AND FRAME.
- A 2" x 4" WOOD FRAME SHALL BE COMPLETED AROUND THE CREST OF THE FABRIC FOR OVER FLOW STABILITY.

**FILTER FABRIC INLET PROTECTION DETAIL (N.T.S.)**

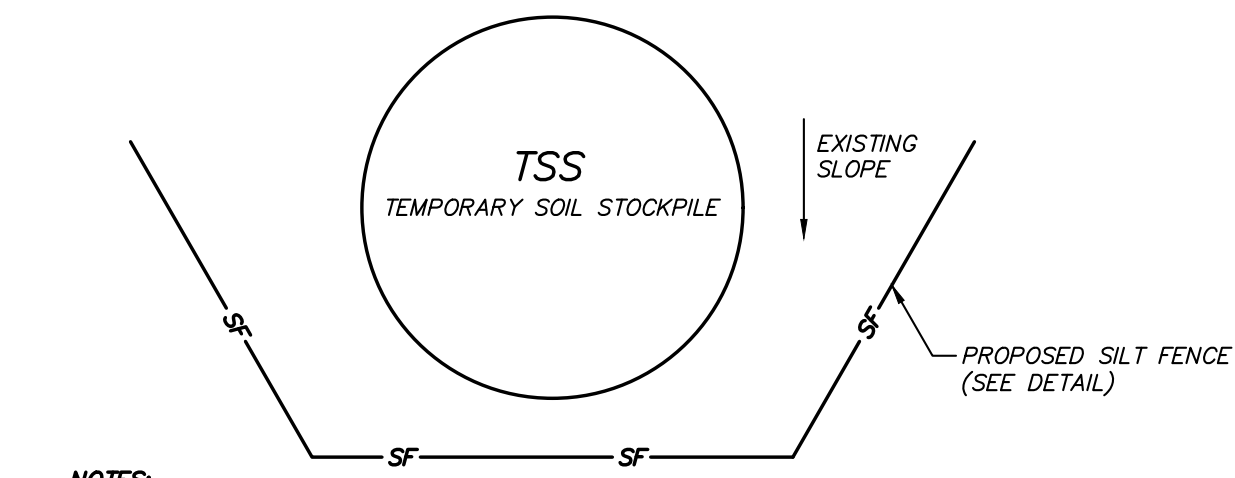
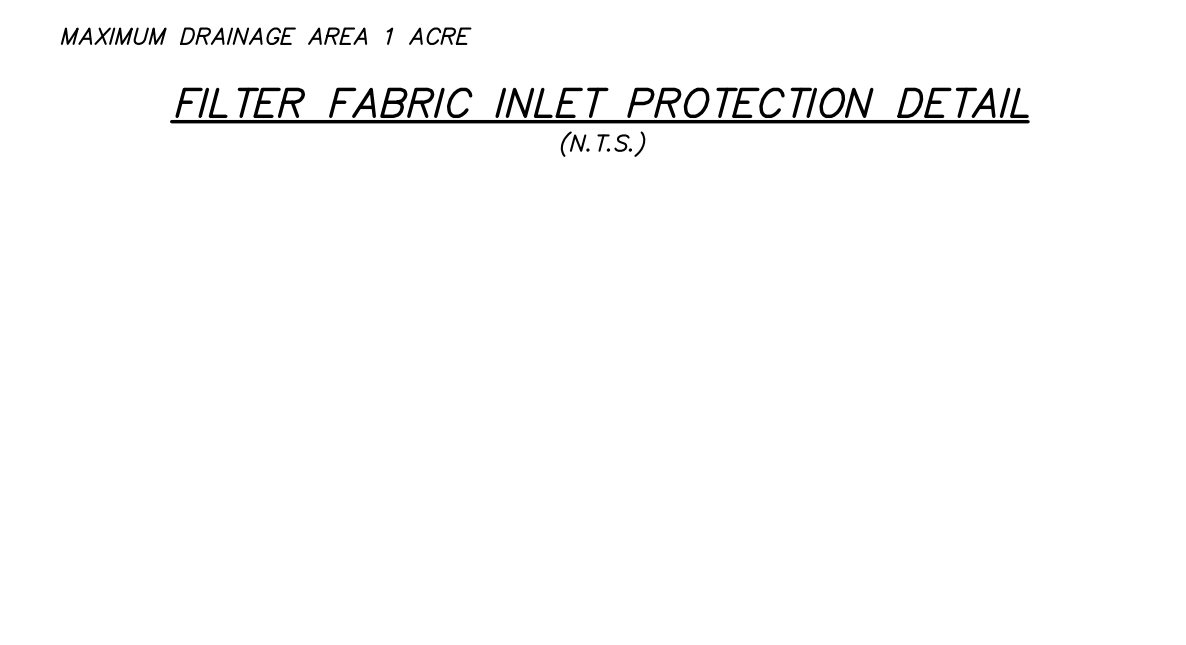

**NOTES**

- AREA CHOSEN FOR STOCKPILE LOCATION SHALL BE DRY AND STABLE.
- MAXIMUM SLOPE OF STOCKPILE SHALL BE 2:1.
- UPON COMPLETION OF SOIL STOCKPILING, EACH PILE SHALL BE IMMEDIATELY SEEZED WITH 4:1 PERMANENT TALL FESQUE.
- ALL STOCKPILES SHALL BE PROTECTED WITH SILT FENCING INSTALLED ON THE DOWNGRADIENT SIDE.

**TEMPORARY SOIL STOCKPILE DETAIL (N.T.S.)**

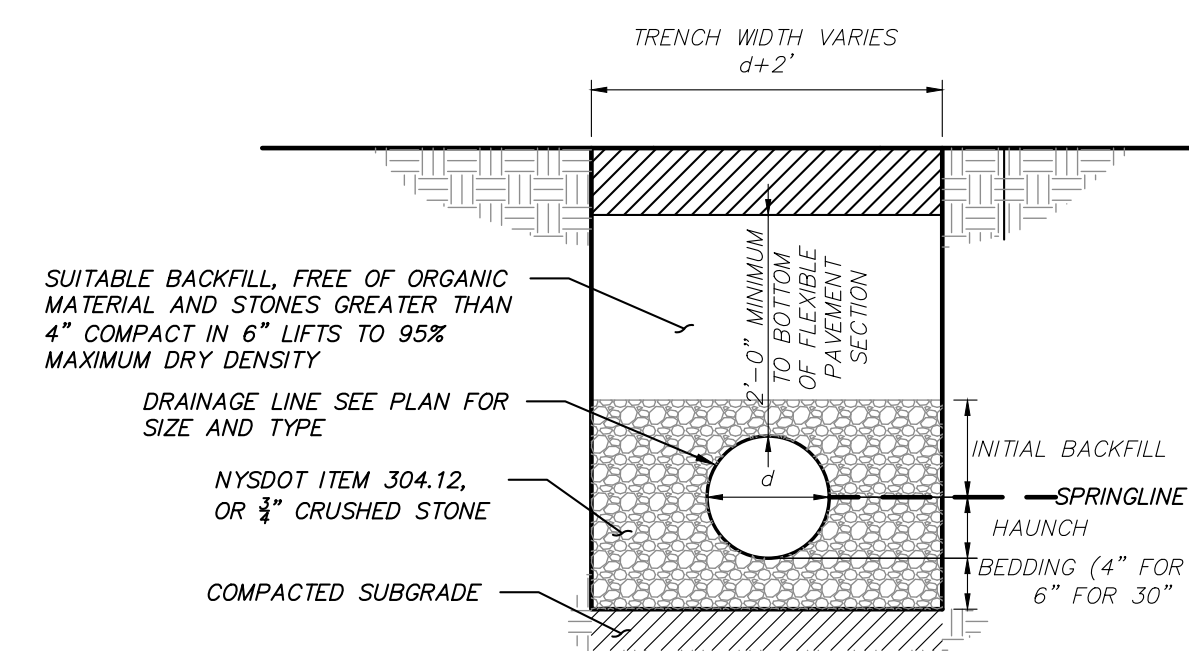

**DRAINAGE LINE TRENCH DETAIL (N.T.S.)**

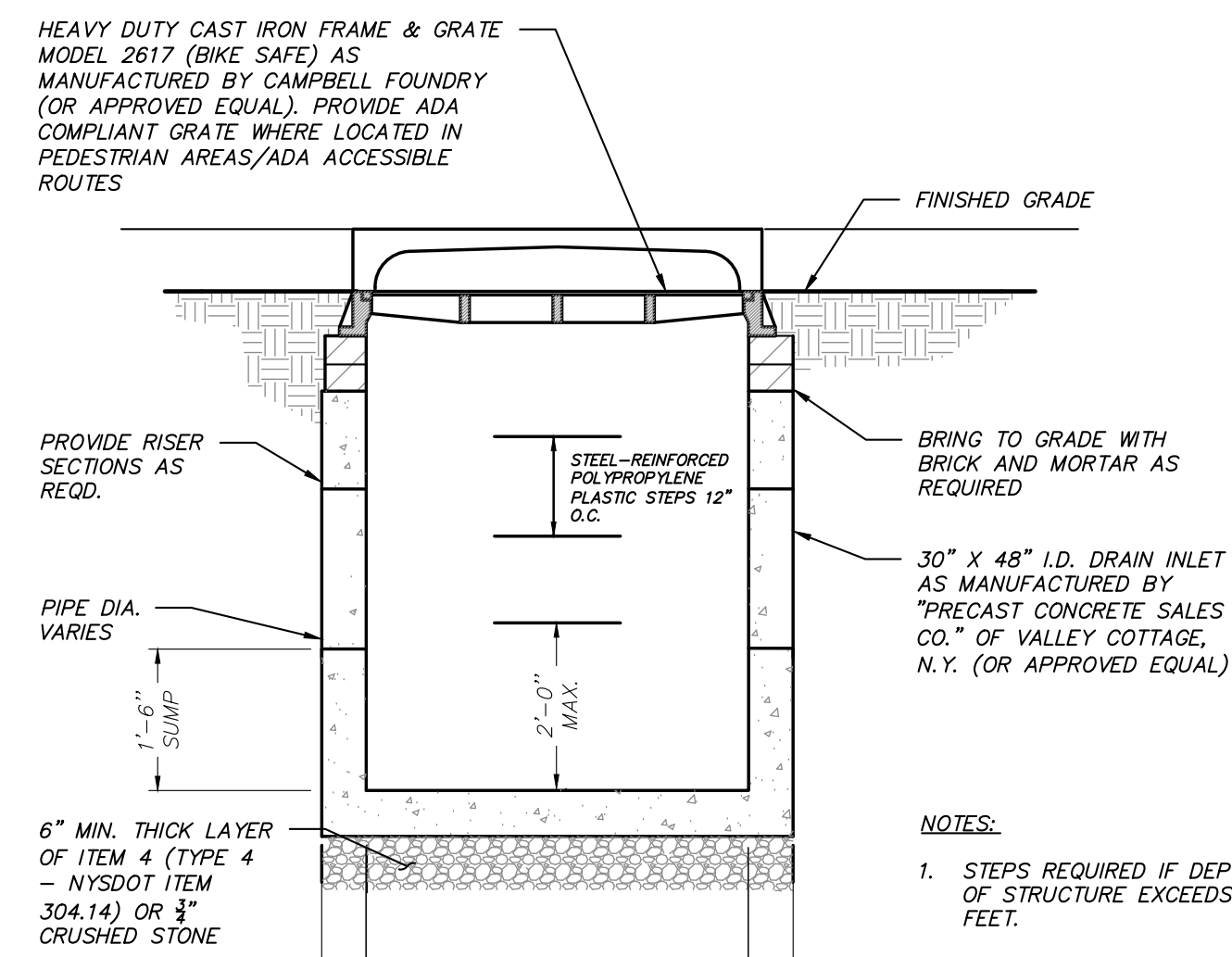

**30\"/>**

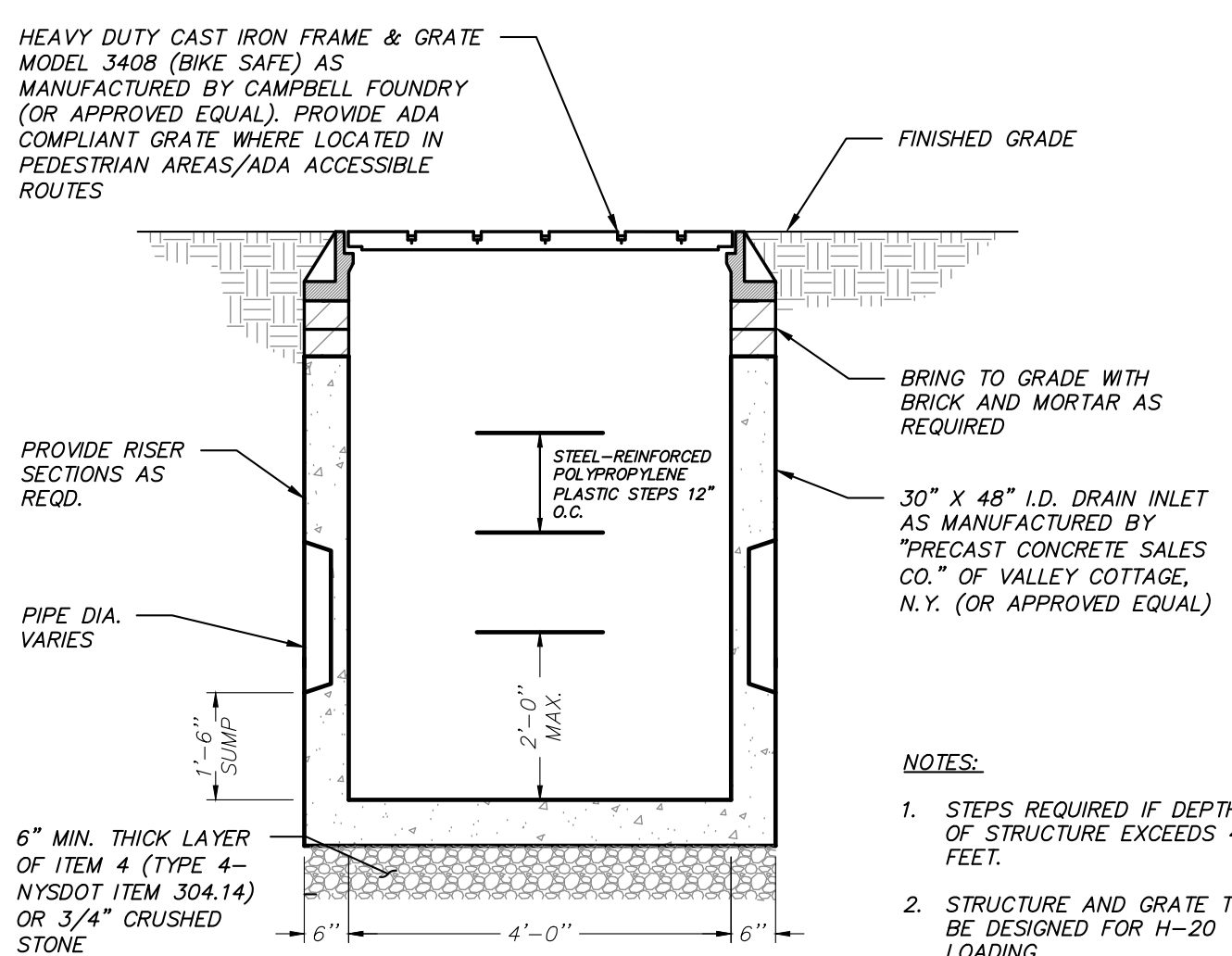

**30\"/>**

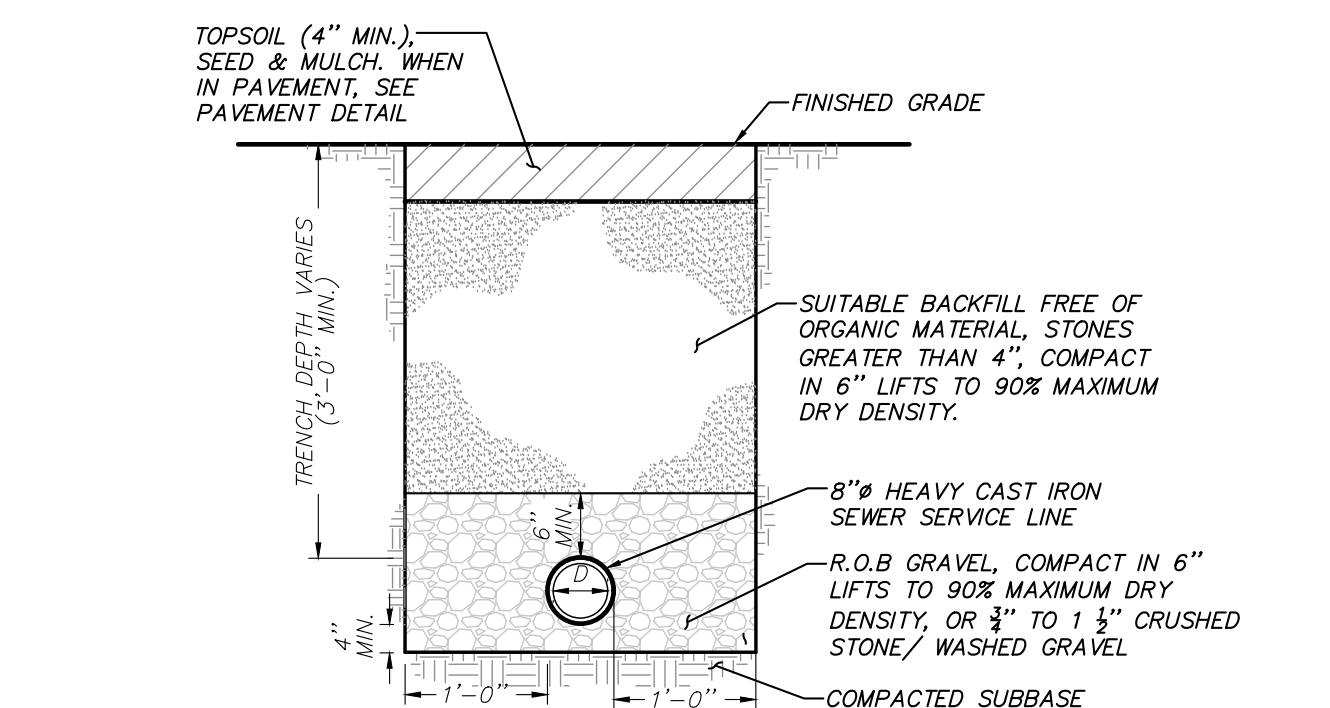

**SEWER SERVICE LINE TRENCH DETAIL (N.T.S.)**

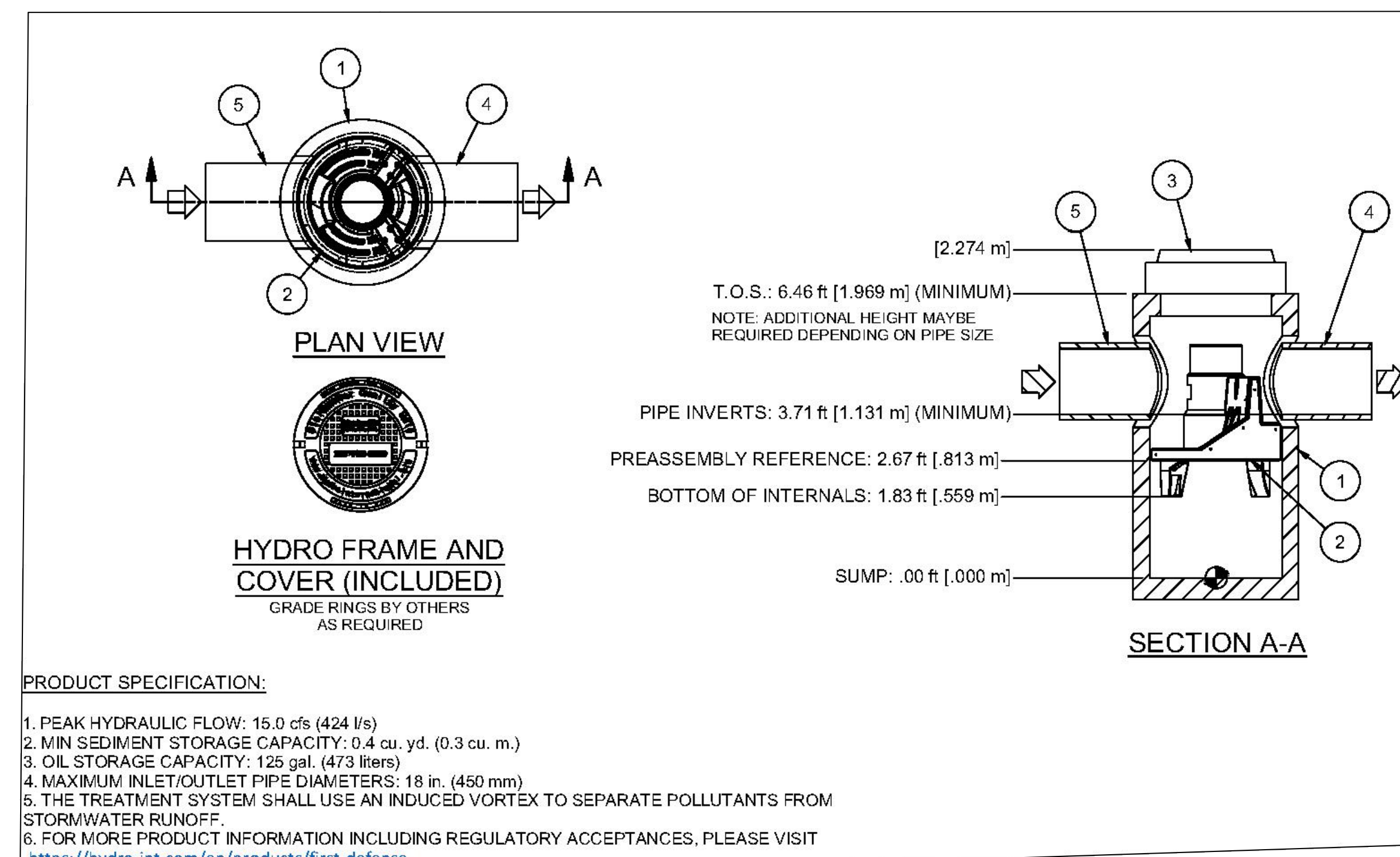

**PRODUCT SPECIFICATION:**

- PEAK HYDRAULIC FLOW: 15.0 cfs (424 l/s)
- MIN SEDIMENT STORAGE CAPACITY: 0.4 cu. yd. (0.3 cu. m.)
- OIL STORAGE CAPACITY: 125 gal. (473 liters)
- MAXIMUM INLET/OUTLET PIPE DIAMETERS: 18 in. (450 mm)
- THE TREATMENT SYSTEM SHALL USE AN INDUCED VORTEX TO SEPARATE POLLUTANTS FROM STORMWATER RUNOFF.
- FOR MORE PRODUCT INFORMATION INCLUDING REGULATORY ACCEPTANCES, PLEASE VISIT <https://hydro-int.com/en/products/first-defense>

**HYDRO INTERNATIONAL 3-FT FIRST DEFENSE HC HYDRODYNAMIC SEPARATOR DETAIL (N.T.S.)**

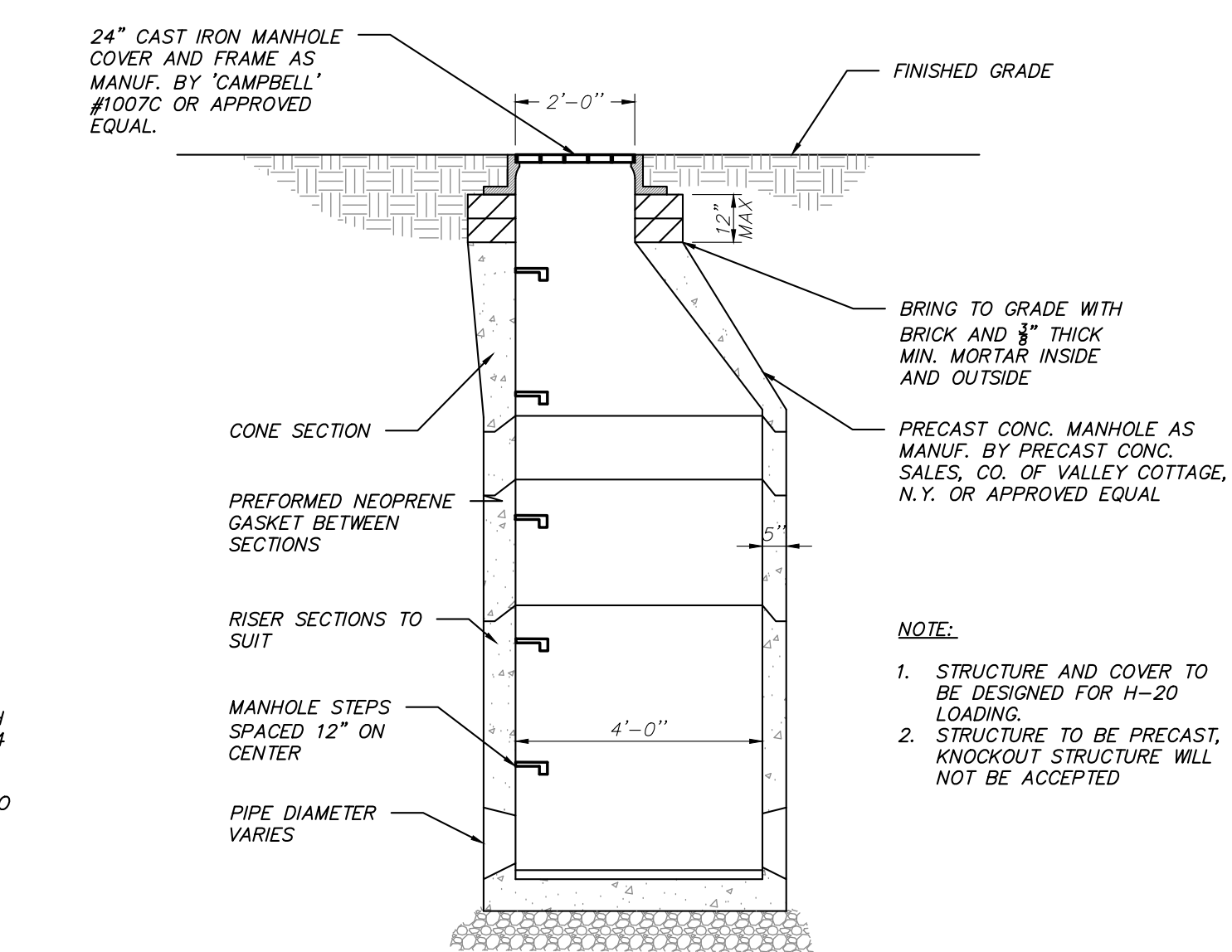

**DRAINAGE MANHOLE DETAIL (N.T.S.)**

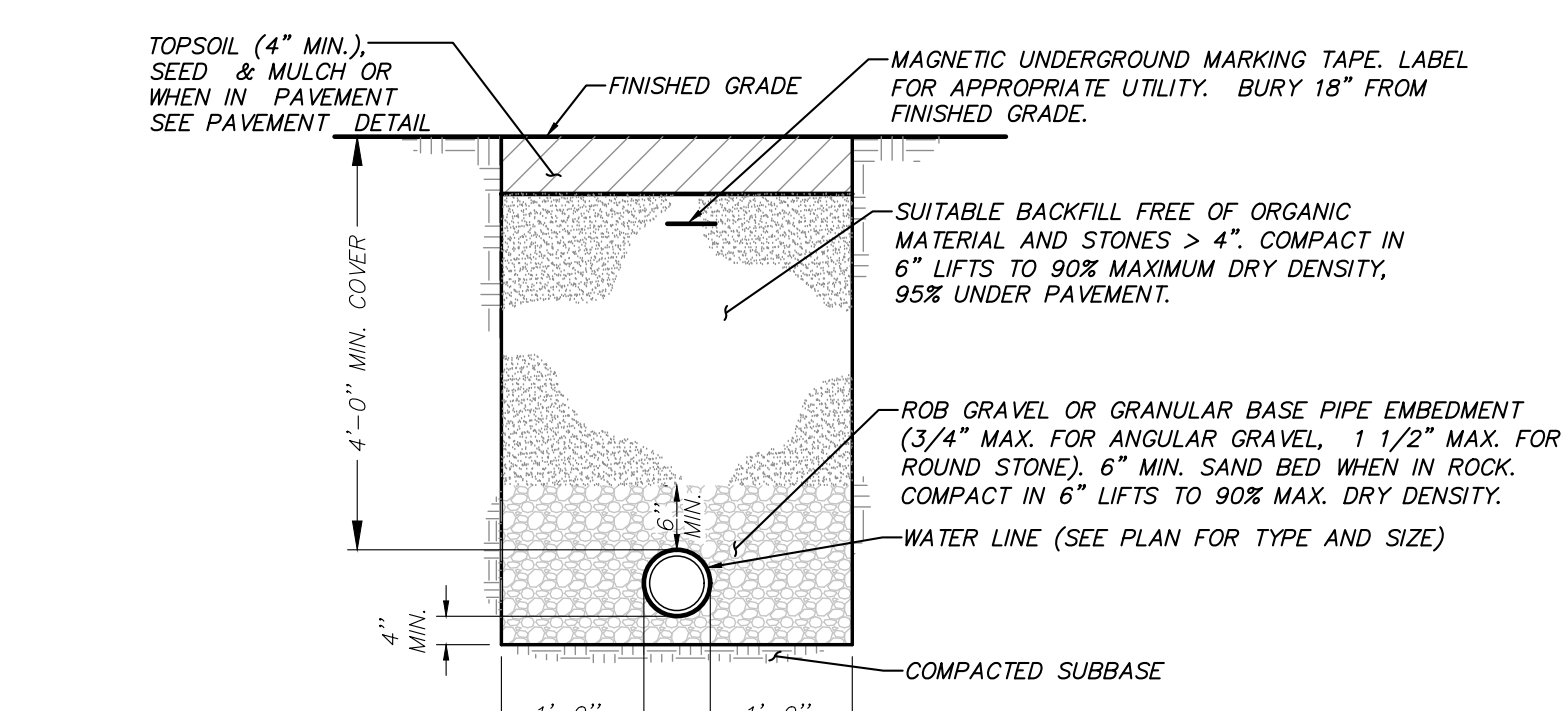

**WATER LINE TRENCH DETAIL (N.T.S.)**

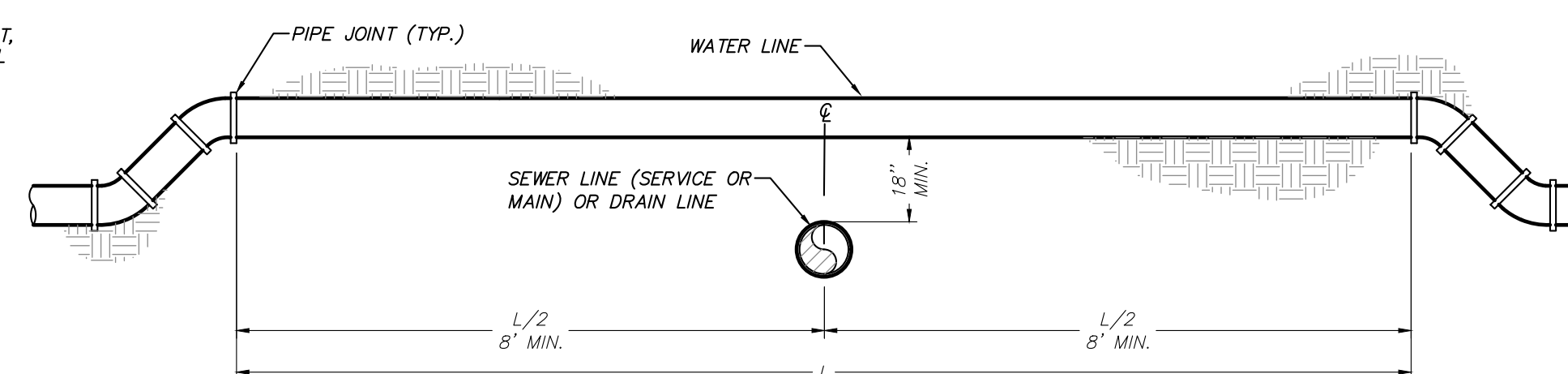

**WATER LINE CROSSING OVER SANITARY SEWER LINE OR STORM DRAIN LINE (N.T.S.)**

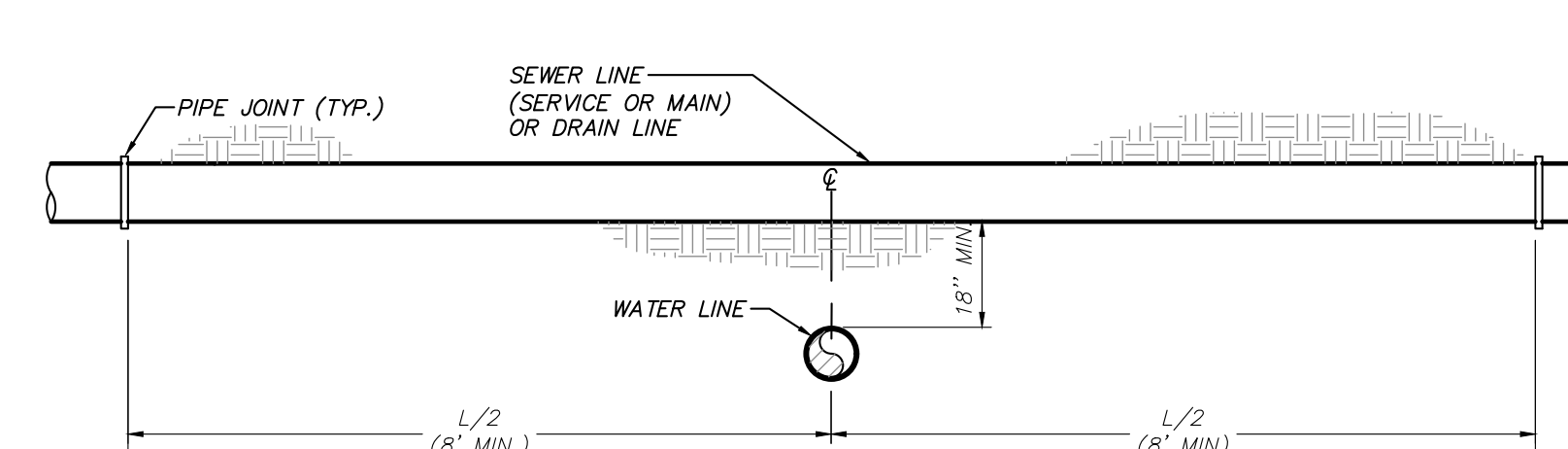

**WATER LINE CROSSING UNDER SANITARY SEWER LINE OR STORM DRAIN LINE (N.T.S.)**

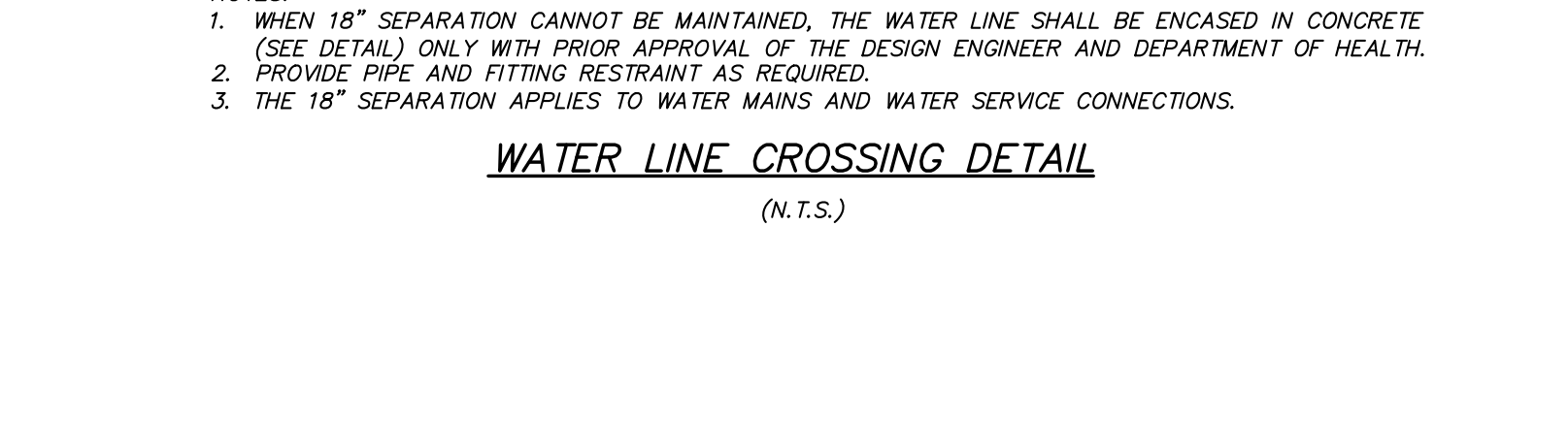

**WATER LINE HORIZONTAL SEPARATION DETAIL (N.T.S.)**

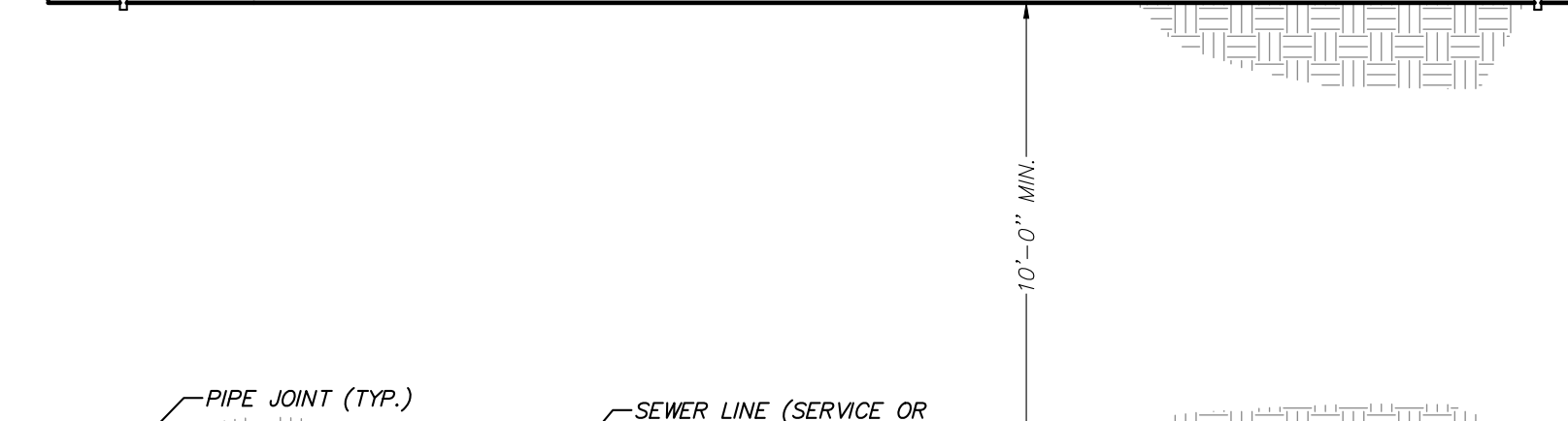

- NOTES:**
- WHEN THE 10' SEPARATION CANNOT BE MAINTAINED, THE WATER LINE SHALL BE ENCASED IN CONCRETE (SEE DETAIL) ONLY WITH PRIOR APPROVAL OF THE DESIGN ENGINEER AND DEPARTMENT OF HEALTH.
  - THE 10' SEPARATION APPLIES TO WATER MAINS AND WATER SERVICE CONNECTIONS.

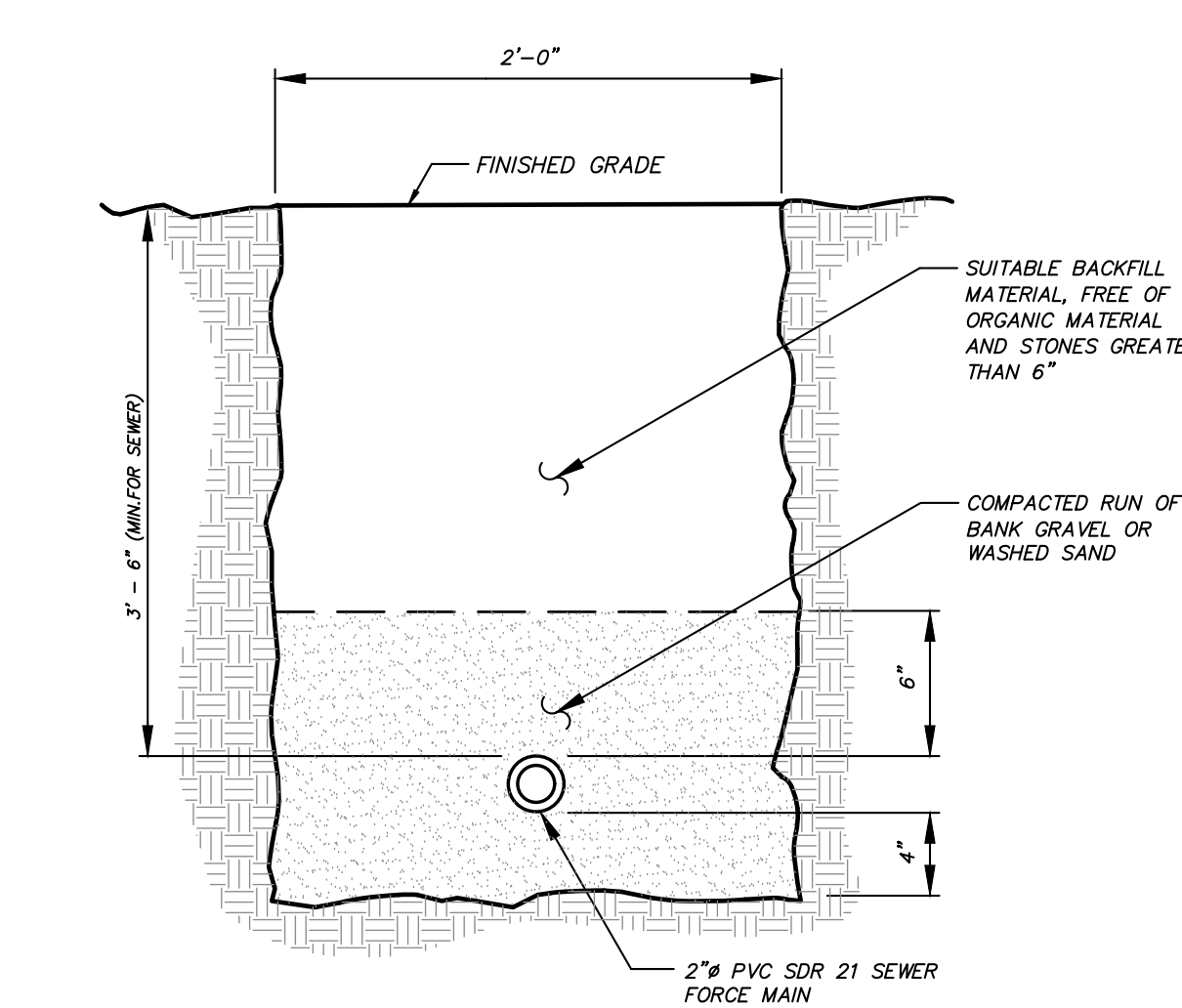

**SEWER FORCE MAIN TRENCH DETAIL (N.T.S.)**

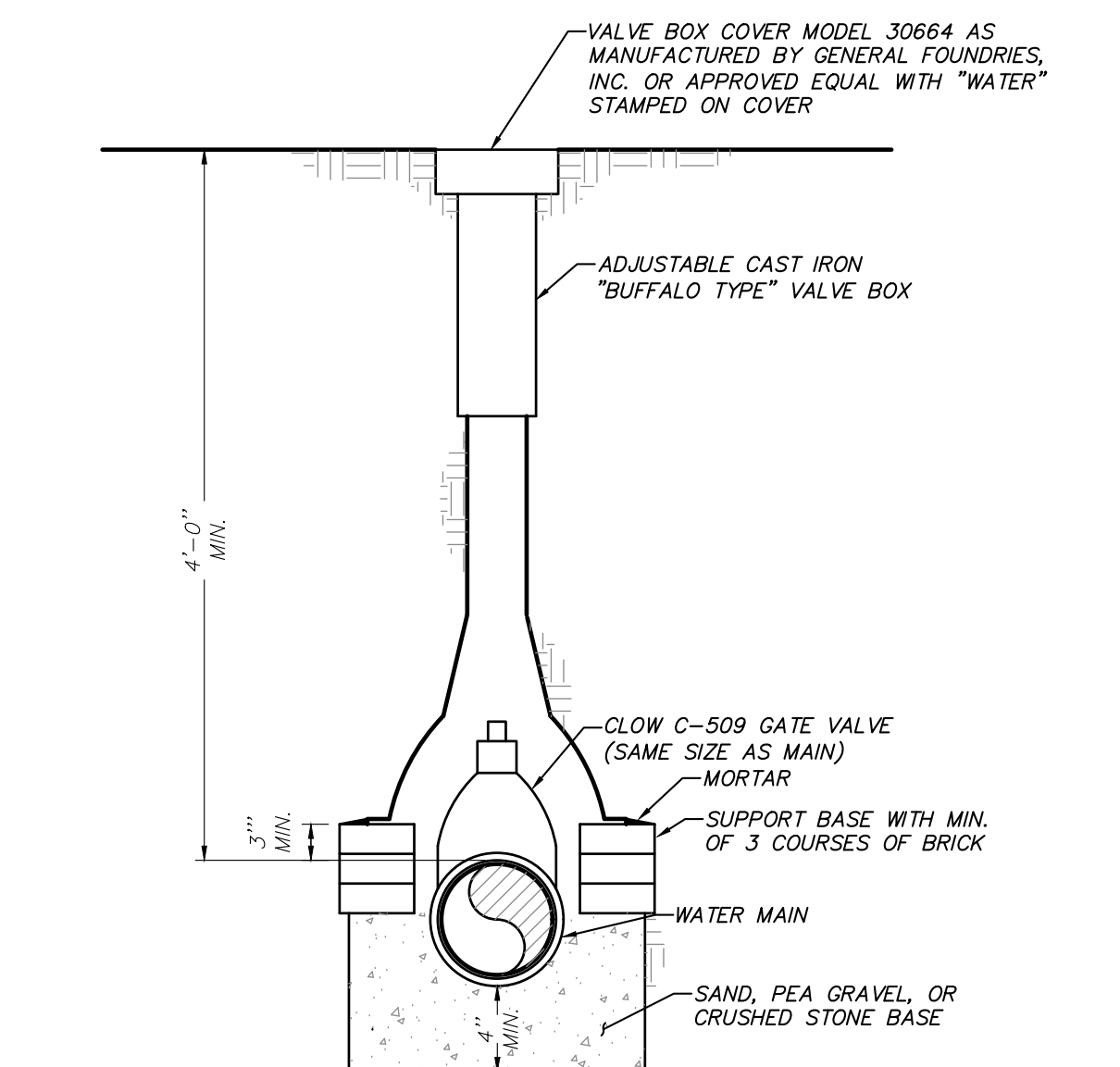

**WATER MAIN GATE VALVE DETAIL (N.T.S.)**

NO.	DATE	REVISION	BY
<b>INSITE</b> ENGINEERING, SURVEYING & LANDSCAPE ARCHITECTURE, P.C.			
PROJECT:		3 Garrett Place Croton, NY 10512 (845) 225-9690 (845) 225-9717 fax www.insite-eng.com	
<b>1 CROTON POINT</b>			
CROTON POINT AVE. & VETERANS PLAZA, VILLAGE OF CROTON-ON-HUDSON, WESTCHESTER CO., NY			
DRAWING:		<b>DETAILS</b>	
PROJECT NUMBER	24154.100	PROJECT MANAGER	R.D.W.
DATE	7-11-24	DRAWN BY	M.E.U.
SCALE	AS SHOWN	CHECKED BY	D.L.M.
DRAWING NO.		SHEET	
D-2		7	