

## CORKSCREW ROAD

2.85 miles from Ben Hill Griffin  
Parkway to Bella Terra Boulevard

Pathway, Lighting, and Landscaping  
Enhancements  
for

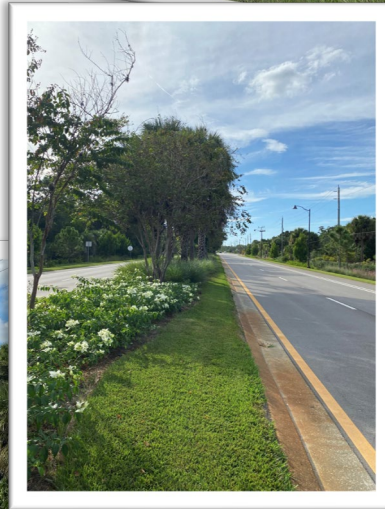



# LANDSCAPE PROJECT LIMITS KEY







# LANDSCAPE DESIGN TREATMENTS FORMAL (WEST END)

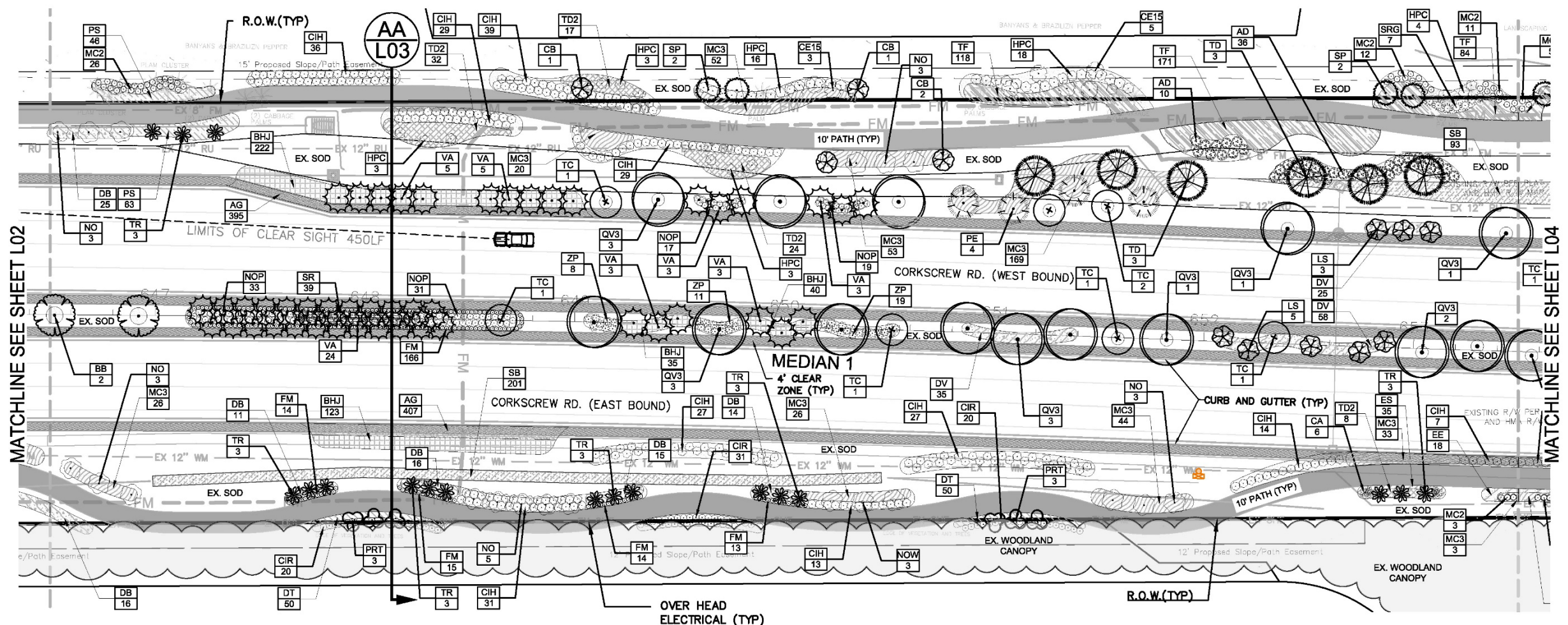

MATCHLINE SEE SHEET L02

MATCHLINE SEE SHEET L04





# LANDSCAPE DESIGN TREATMENTS FORMAL (WEST END)

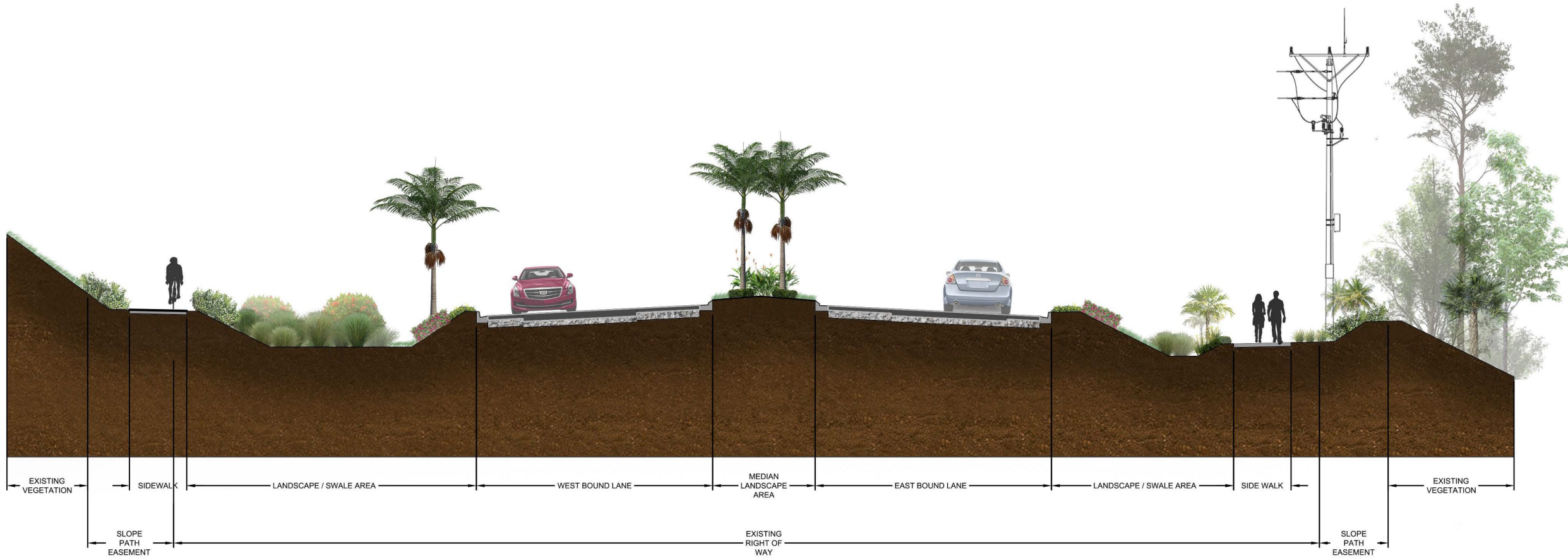







# LANDSCAPE DESIGN TREATMENTS WEST TRANSITIONAL (WEST OF WILDLIFE CROSSING)

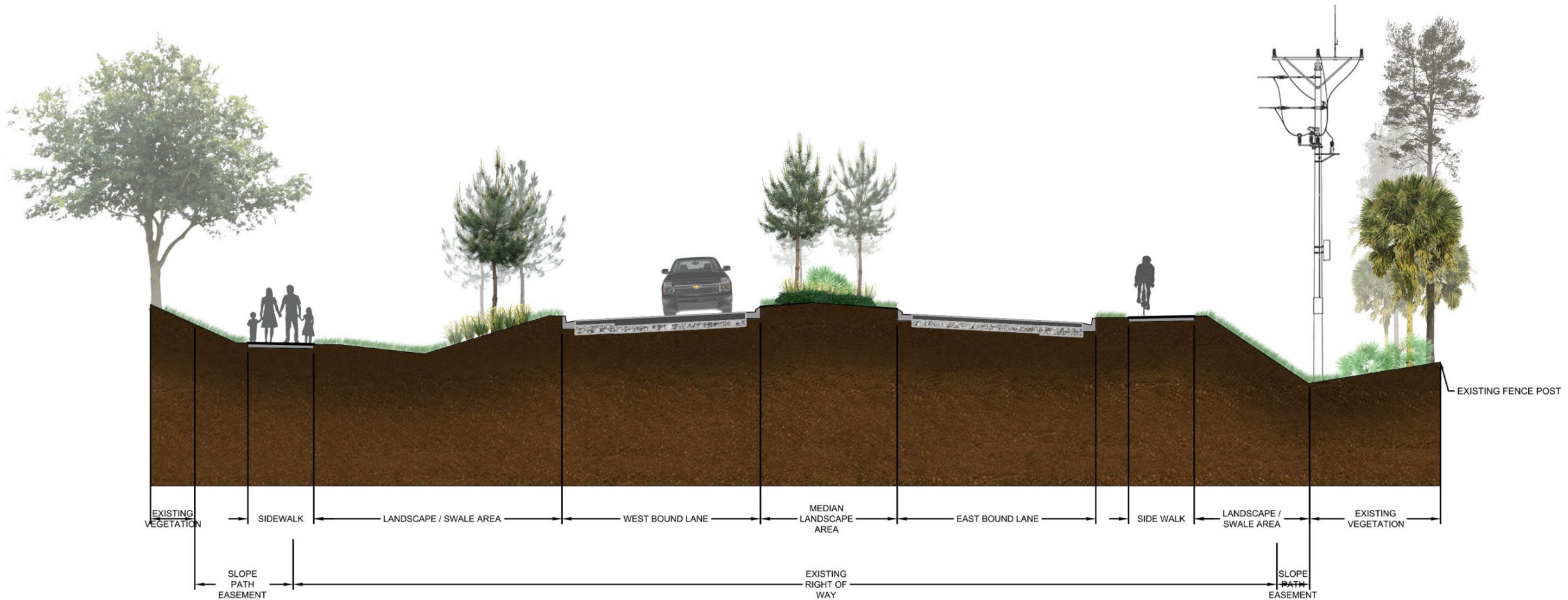



# LANDSCAPE DESIGN TREATMENTS INFORMAL (WILDLIFE CROSSING)

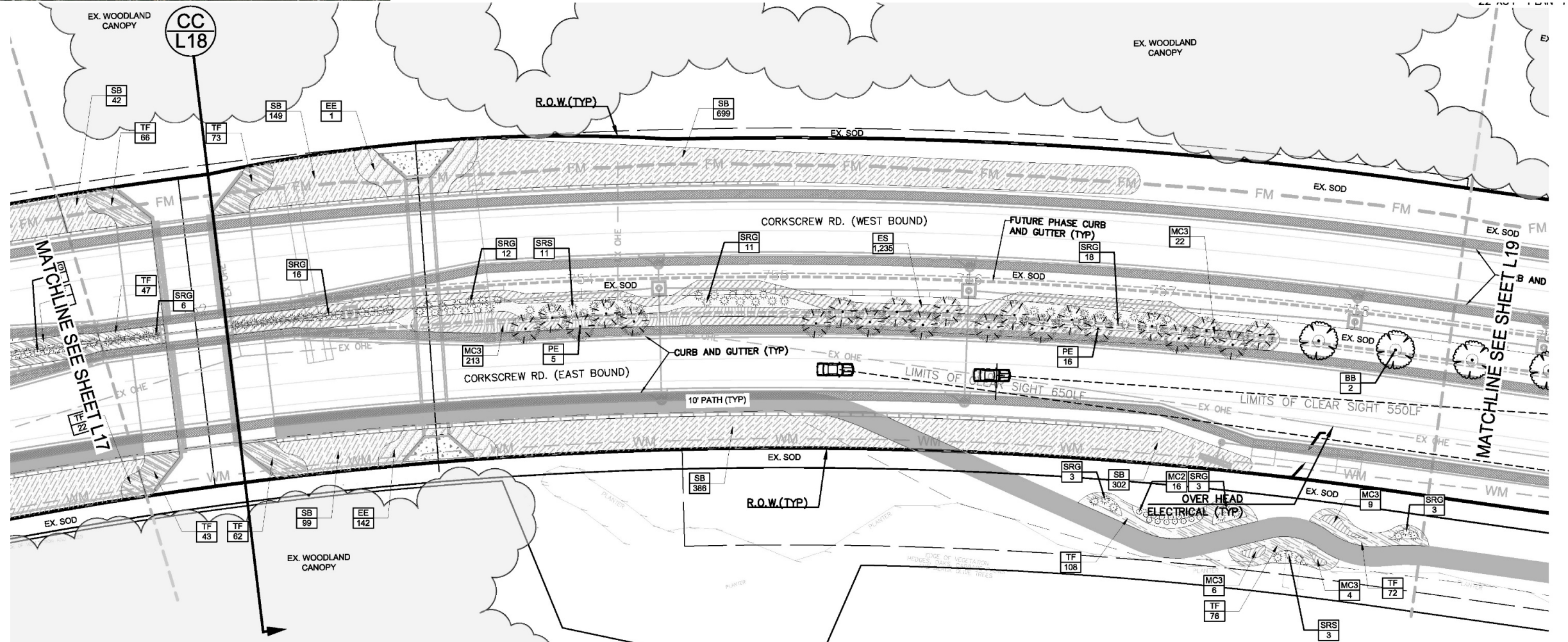



# LANDSCAPE DESIGN TREATMENTS INFORMAL (WILDLIFE CROSSING)

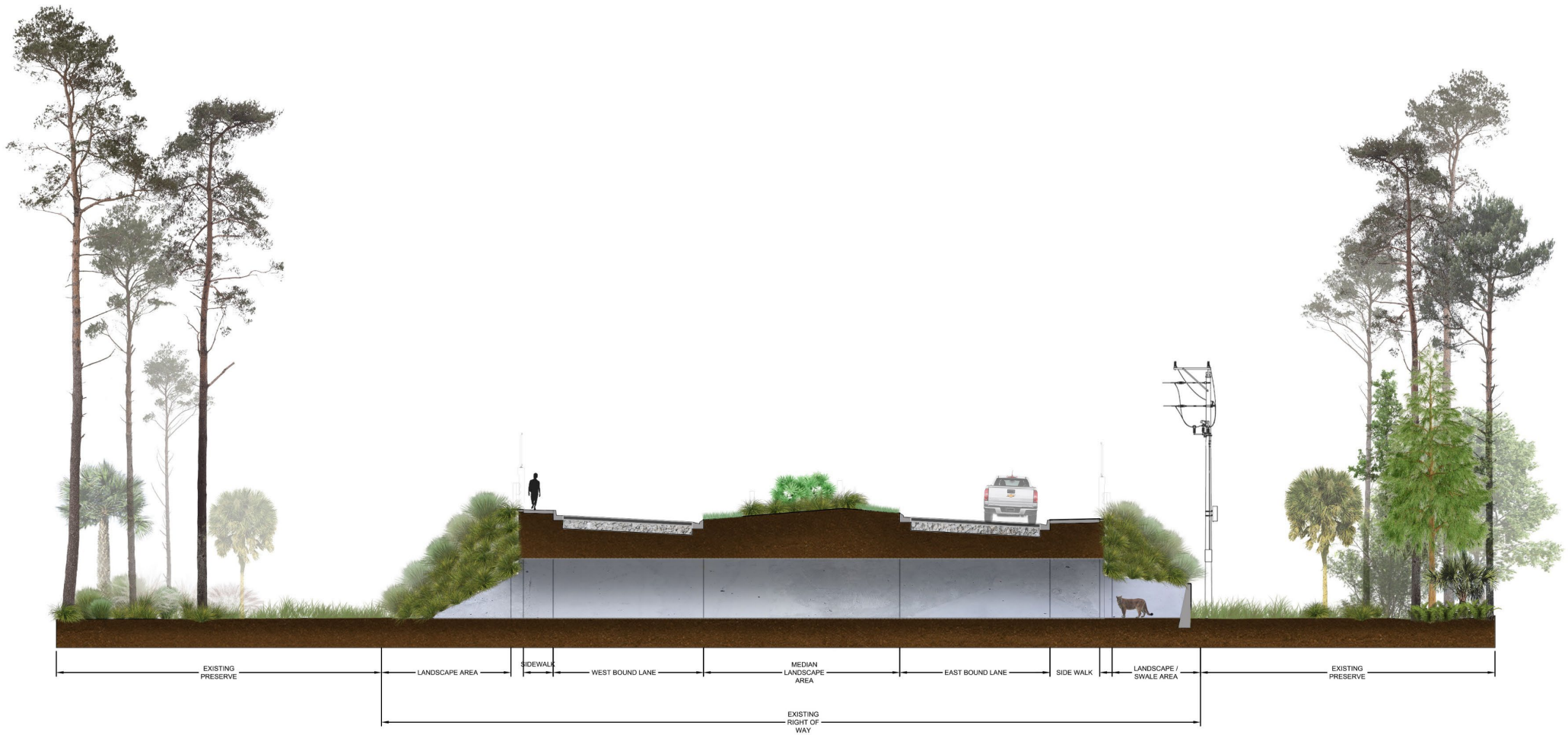









# LANDSCAPE DESIGN TREATMENTS EAST TRANSITIONAL (WILDLIFE CROSSING TO VILLAGE LINE)

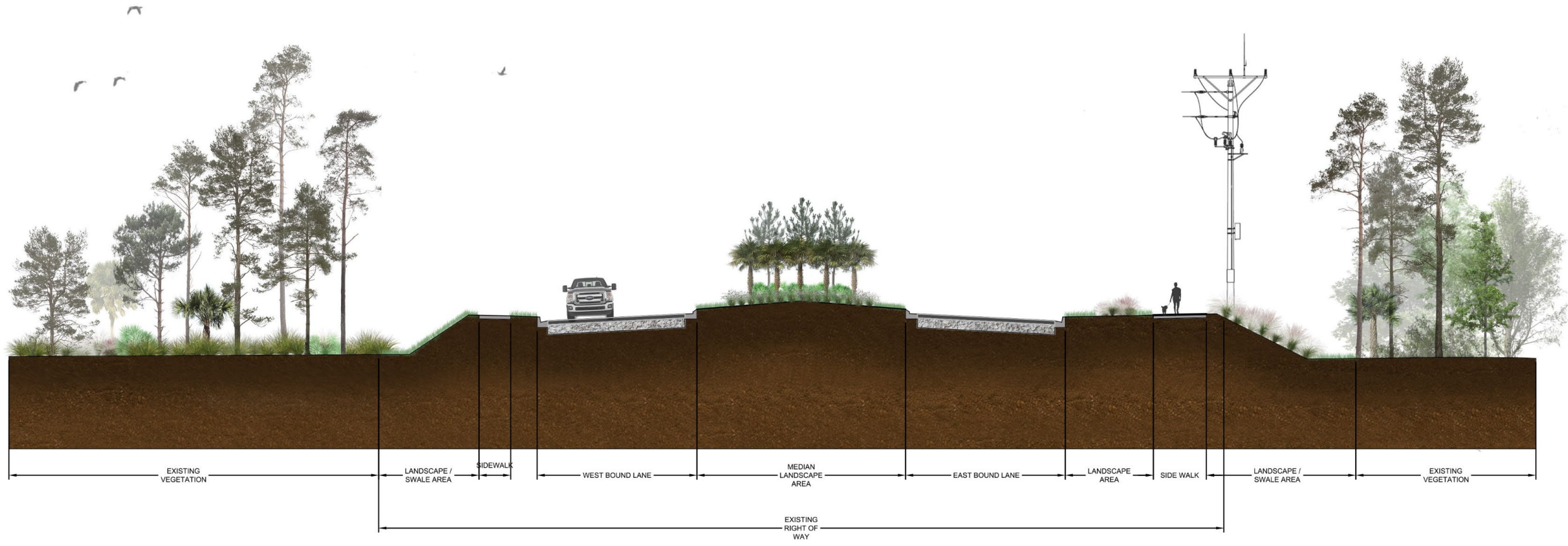



# AREAS OF SPECIAL LANDSCAPE TREATMENT LINEAR STORMWATER AREAS

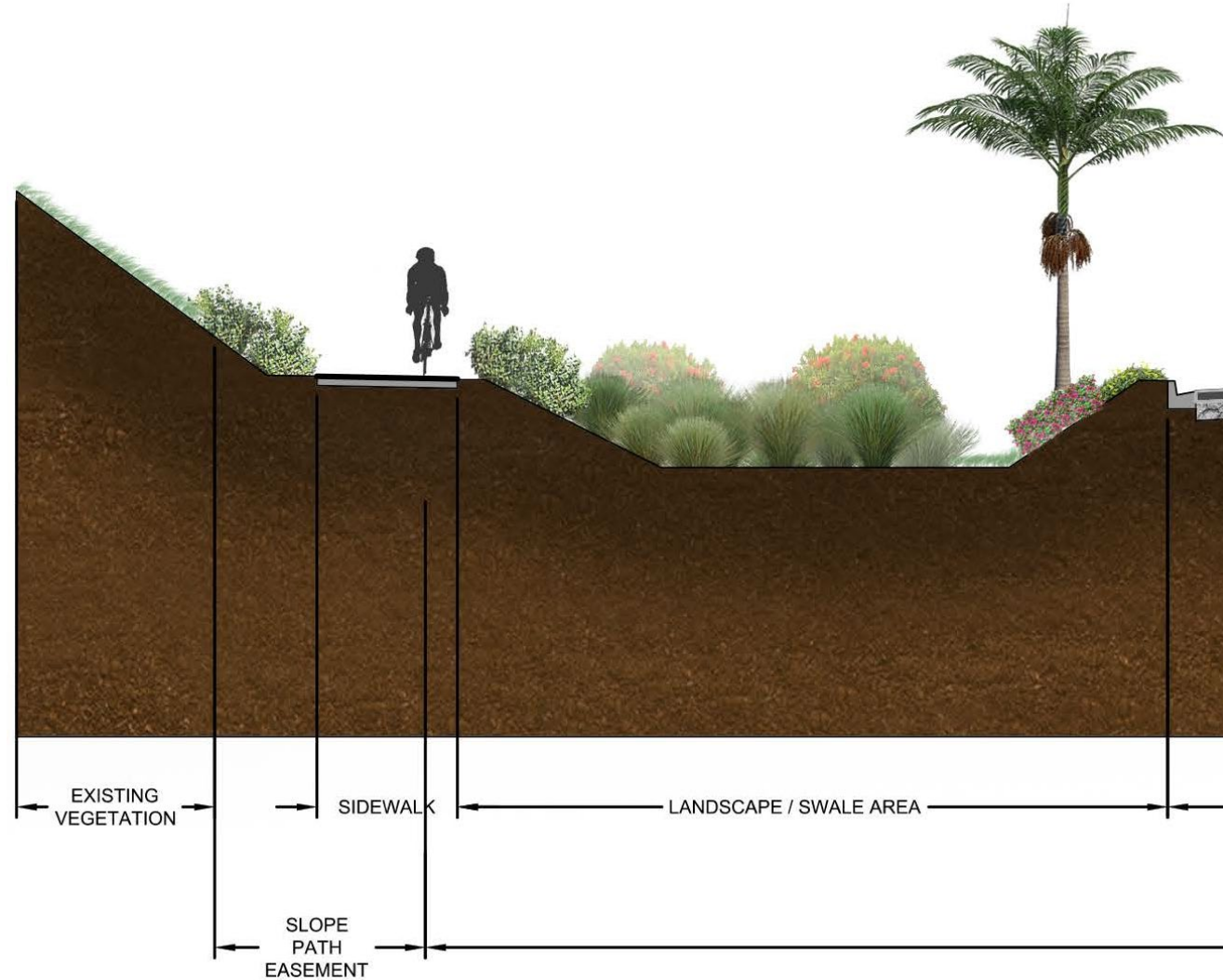











# TURF TYPES FOR CONSIDERATION BAHIA - VS - SAINT AUGUSTINE

## BAHIA

- Established by seed or sod
- Durable to foot & vehicle traffic
- Not uniform coverage
- Irrigate as needed (.25" - .5")
- No thatch layer
- Mowing as needed (4" - 4.5" ht.)
- Clipping pickup not needed
- Herbicide tolerant
- Limited susceptibility to insect, disease, nematodes
- Chemical applications 2 - 3 times yearly

## SAINT AUGUSTINE

- Established By Sod, Plugs, Sprigs
- Limited Durability To Foot & Vehicle Traffic
- Uniform Coverage
- Irrigate Regularly (.5" - .75"/2-3 Times Weekly)
- Thatch Layer Requiring Maintenance/Dethatching
- Weekly Mowing (3.5" - 4" Ht.)
- Heavy Clippings Need Pickup
- Not Tolerant To Atrazine Herbicides
- High Susceptibility To Insect, Disease, Nematodes
- Chemical Applications 2 - 6 Times Yearly



# RECOMMENDED TURF SELECTIONS & LOCATIONS

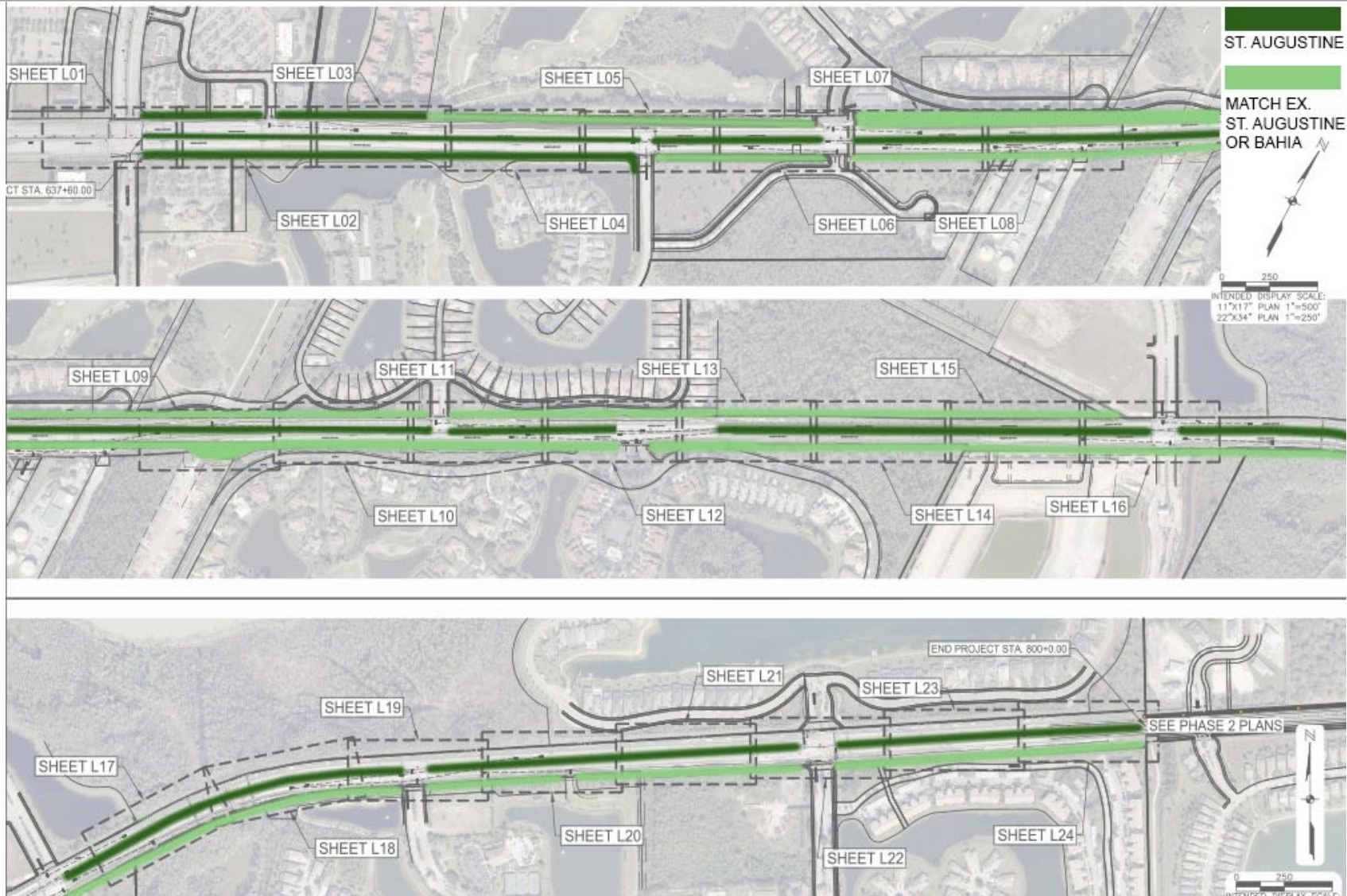



# PLANT PALETTE SELECTIONS TREES & PALMS

## CANOPY TREES



Bald Cypress (N, FF)

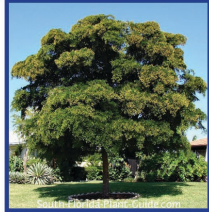

Shady Lady Black Olive (NN, FF) ●



Florida Red Maple (N, FF) ●

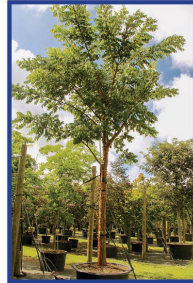

Gumbo Limbo (N, FF) ●



Southern Live Oak (N, FF) ●



Wax Myrtle Tee (N, FF) ●



Laurel Oak (N, FF)



Green Buttonwood (N, FF) ●



Pigeon Plum Tree (N, FF) ●



SF Flash Pine (N, FF) ●



Dahoon Holly (N, FF) ●

## PALMS



Montgomery Palm (NN, FF)



Solitaire Palm (NN, FF)



Sabal Palm (N, FF) ●



Royal Palm (N, FF)  
*clear of roads and sidewalks*

● Plant utilized on Estero Parkway project

Native (N)  
Non-Native (NN)  
Florida Friendly (FF)



# PLANT PALETTE SELECTIONS ACCENT TREES & PALMS

## ACCENT TREES



Crape Myrtle (NN, FF) ●



Japanese Blueberry Tree (NN) ●



Orange Geiger (N, FF)  
*limited use only*



Queen Crape Myrtle (NN, FF)



Royal Poinciana Tree (NN, FF)  
*limited to large space only*

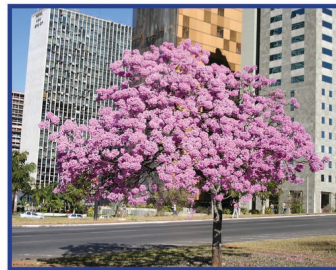

Pink Trumpet Tree (N, FF) ●



Silver Buttonwood Tree (N, FF)

## ACCENT PALMS



Alexander Palm (NN, FF) ●



Bismark Palm (NN, FF) ●



Florida Thatch Palm (N, FF) ●



Chinese Fan-Palm (NN, FF) ●

● Plant utilized on Estero Parkway project

Native (N)  
Non-Native (NN)  
Florida Friendly (FF)



# PLANT PALETTE SELECTIONS LARGE & SMALL SHRUBS

## LARGE SHRUBS



Cardboard Plant (NN, FF)



Crinum Lily (NN, FF)

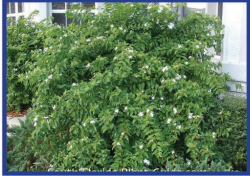

Downey Jasmine (NN, FF) ●



Dwarf Firebush (NN, FF)  
*limited to large space only*



Green Saw Palmetto (N, FF) ●



Green Buttonwood (N, FF) ●



Red Tip Cocoplum (N, FF)  
*limited to large space only* ●



Silver Buttonwood (N, FF) ●



Orange Bird of Paradise (NN, FF)



Silver San Palmetto (N, FF) ●



Small Leaf Clusia (NN)



Sweet Viburnum (NN, FF)



Simpson Stopper (N, FF)

## SMALL SHRUBS



Emerald Blanket Natal Plum (NN, FF) ●



Coontie (N, FF) ●



Dwarf Blue Porterweed (N, FF) ●



Dwarf White Bougainvillea (NN, FF) ●  
*Miss Alice-White*

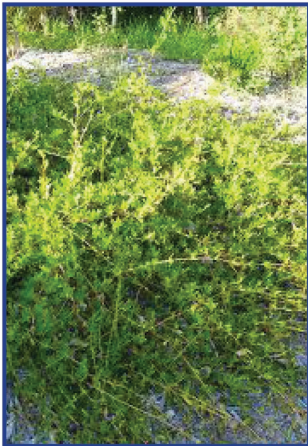

Golden Creeper (N, FF)



Dwarf Small Leaf Clusia (NN)



Dwarf Pink Bougainvillea (NN, FF) ●  
*Helen Johnson - Pink Silhouette - Pink/Lavendar*

● Plant utilized on Estero Parkway project

Native (N)  
Non-Native (NN)  
Florida Friendly (FF)



# PLANT PALETTE SELECTIONS GRASSES & GROUNDCOVER

## GROUNDCOVER



African Iris (NN, FF)



Asiatic Jasmine (NN, FF) ●



Sword Fern (N, FF) ●



Perennial Peanut (NN, FF)



Sunshine Mimosa (N, FF)



Southern Shield Fern (N, FF) ●



Leather Fern (N, FF) ●  
*limited to large space only*

## GRASS



Elliotts Lovegrass (N, FF)



Muhley Grass (N, FF) ●



Purple Lovegrass (N, FF)



Fakahatchee Grass (N, FF) ●



Sand Cordgrass (N, FF) ●

● Plant utilized on Estero Parkway project

Native (N)  
Non-Native (NN)  
Florida Friendly (FF)





## FIXTURE INFORMATION

- Cyclone Domia  
Pendant w/ Housing  
Shields
  - 3,000 K
  - Side Mounted







## ESTERO PARKWAY

- Cyclone Domia –Side Mount
- 28-foot Mounting Height



# TYPICAL SECTION – CONDITION 1

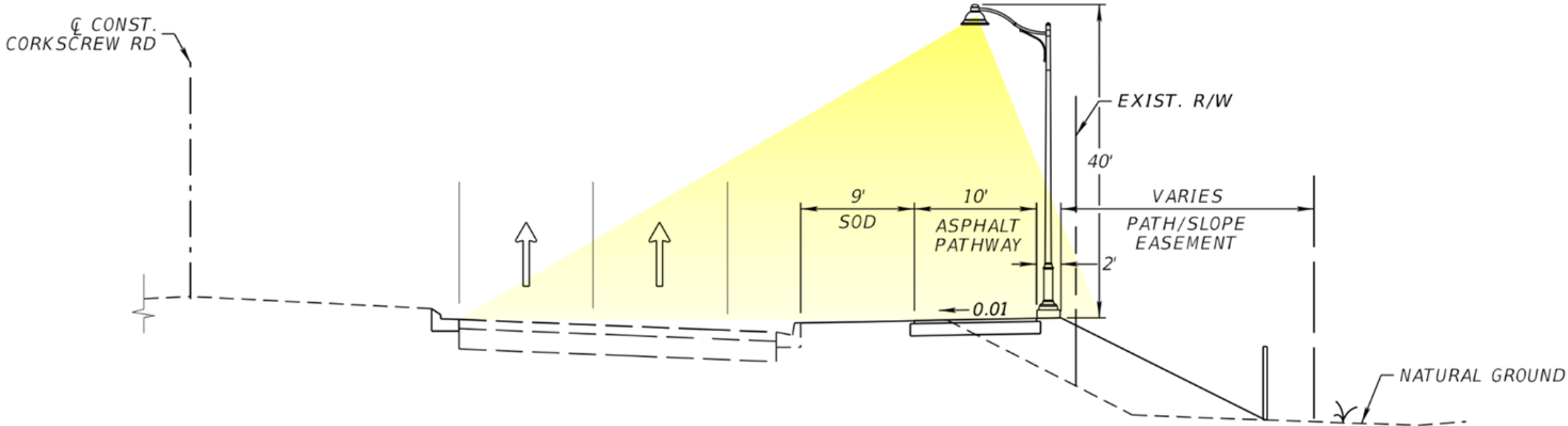



# TYPICAL SECTION – CONDITION 2

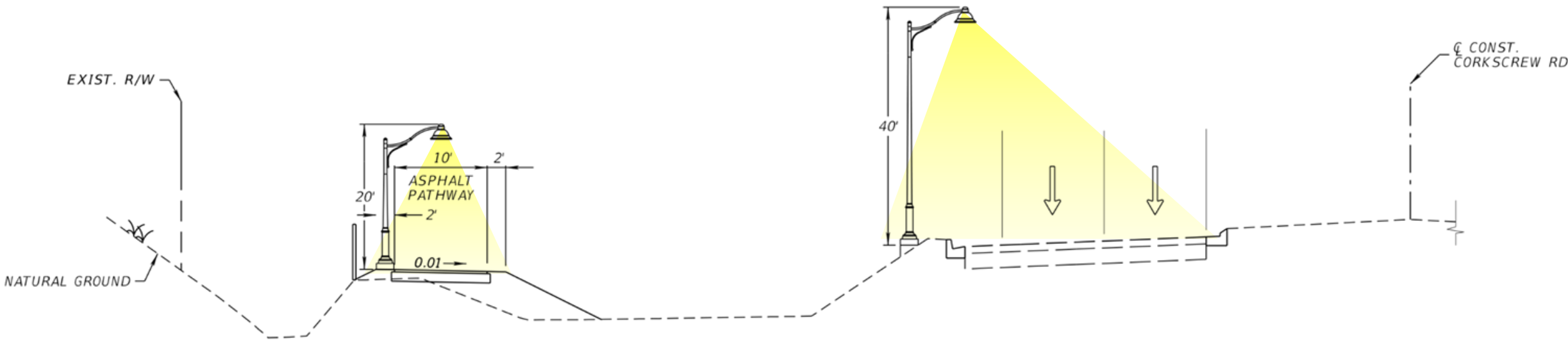



# TYPICAL SECTION – CONDITION 3

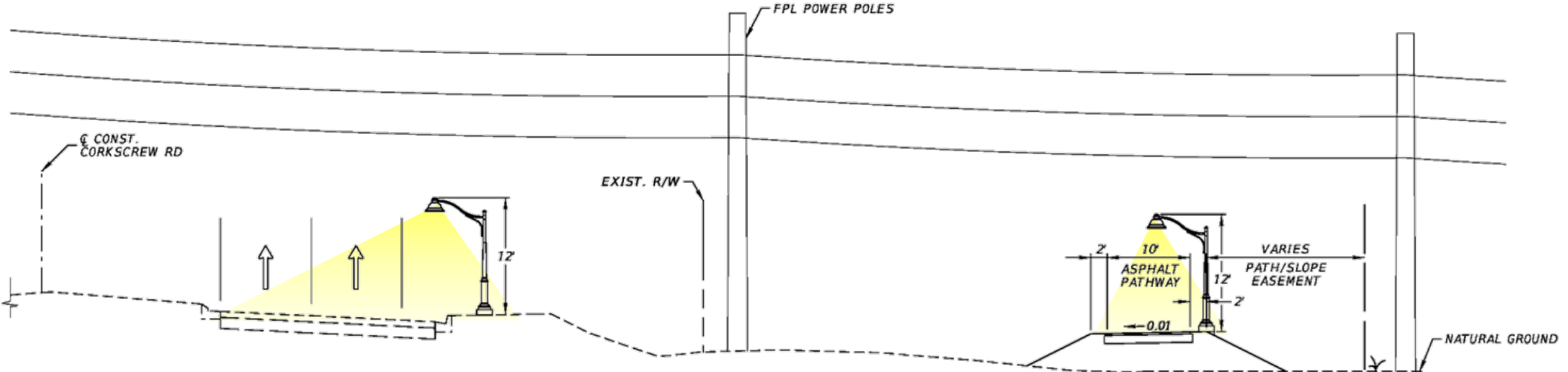



# LIGHTING PLAN #1

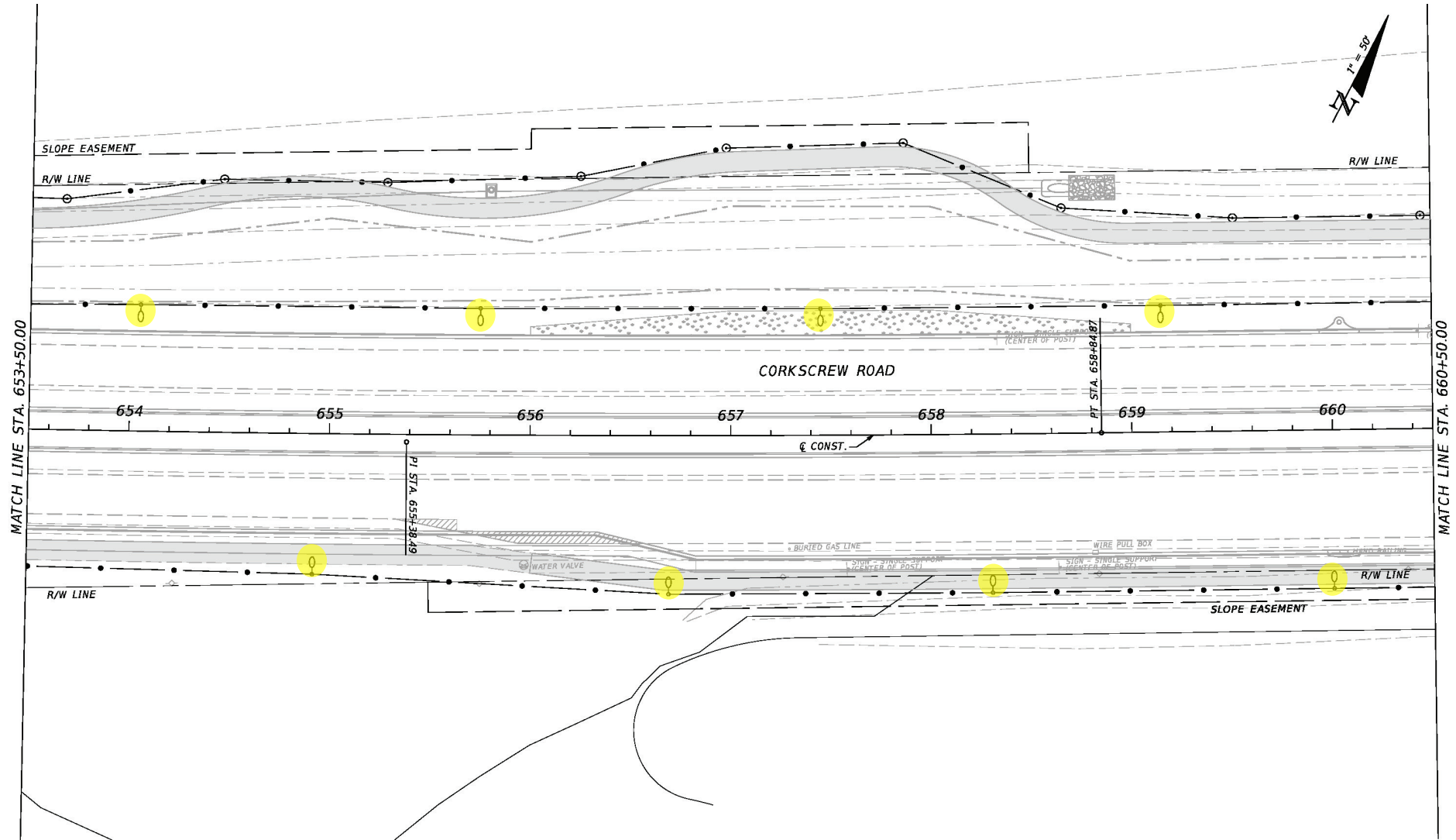

# LIGHTING PLAN #2

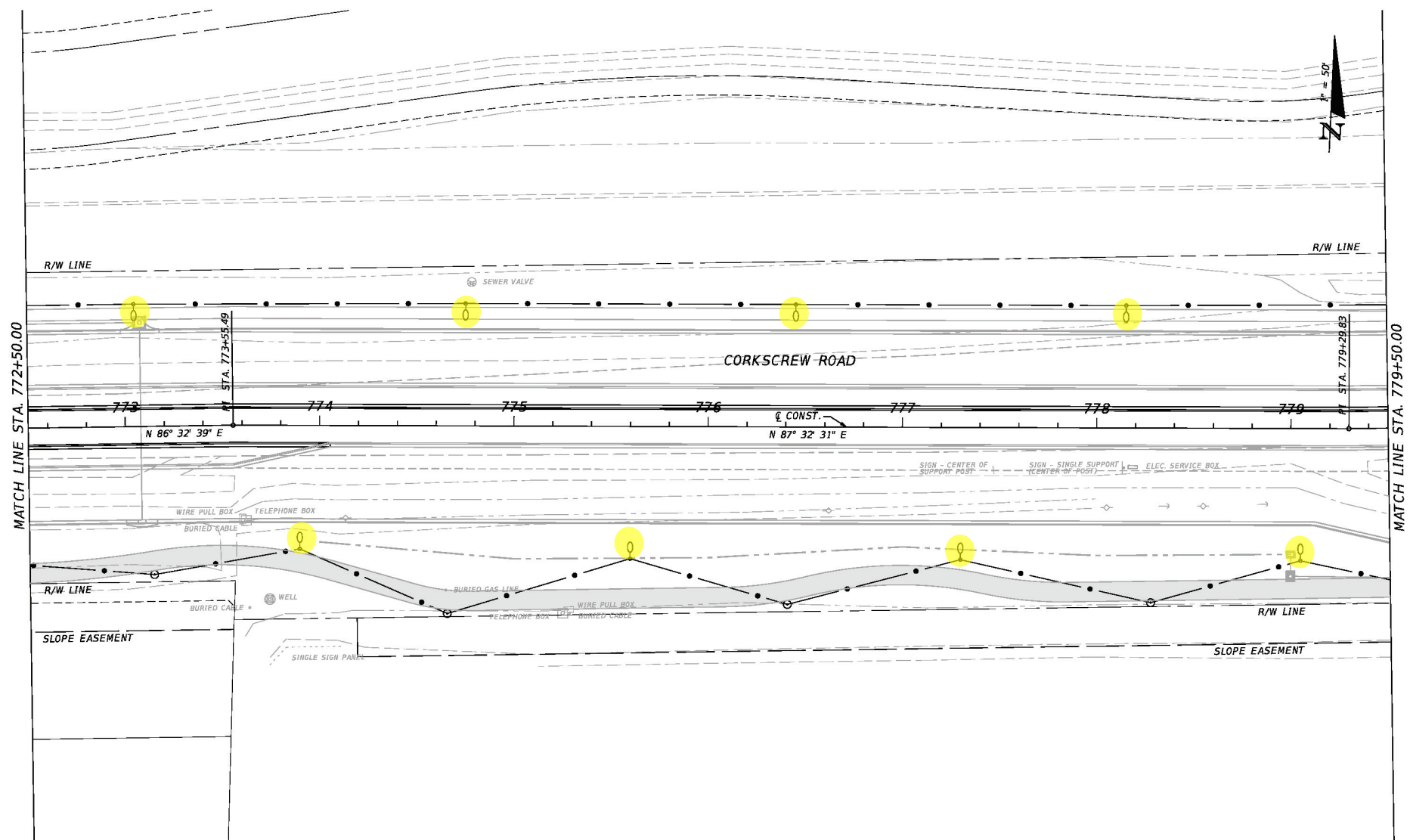



# LIGHTING PLAN #3

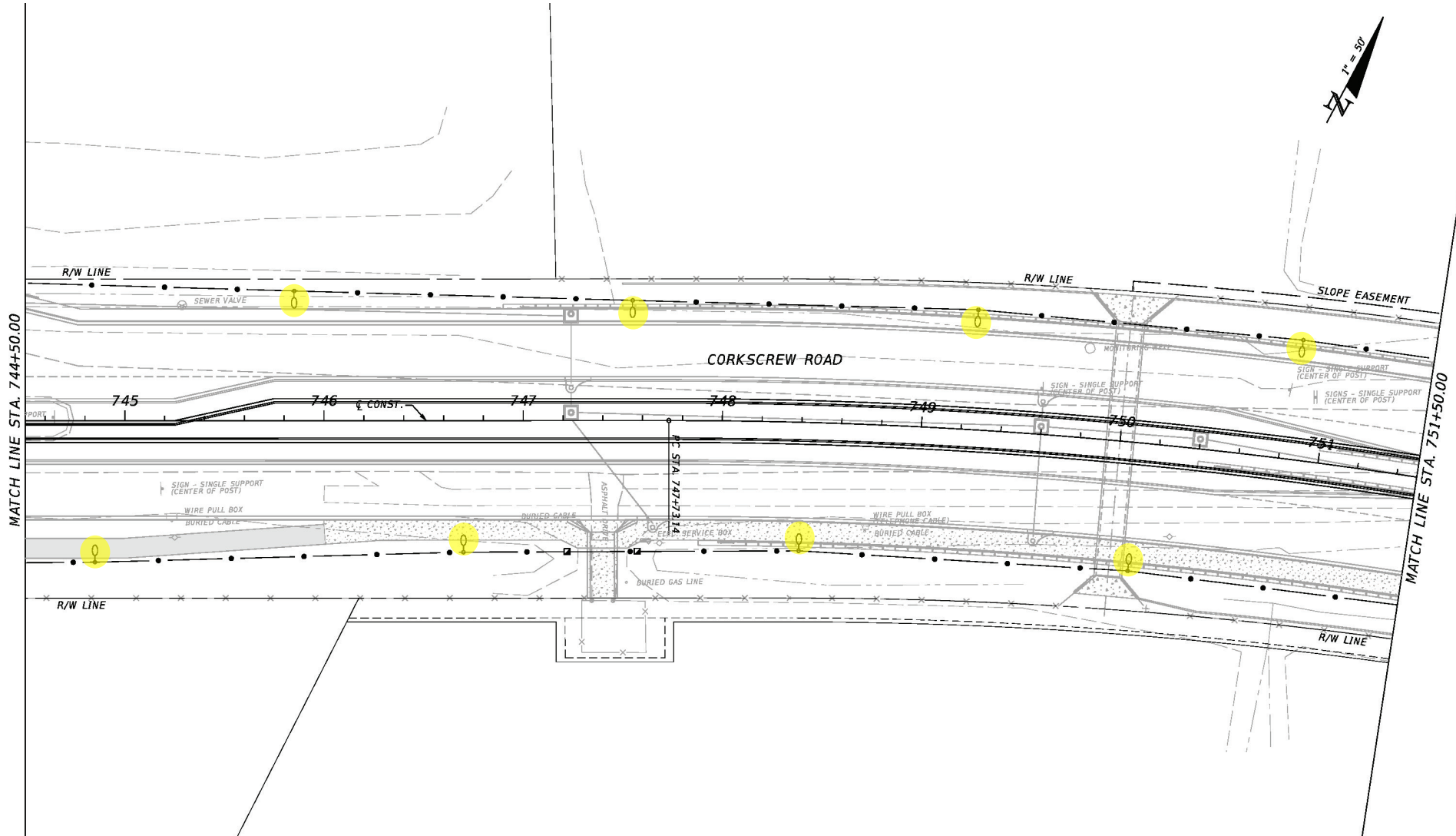

# PATHWAY MATERIALS

ASPHALT



CONCRETE

